

NOTICE!!

These documents have been scanned!

Do not place un-scanned documents beneath this notice!

Do not remove this notice from this file!

GPO Jacket No. 560-102
Print Order 61540
Rise Business Services, LLC
Job=AZ15 5/13/2019



Box Number= AZ15039



Claim Begin-End: AMC423704-AMC423704

1 Initial Receipt



AZ15039-14

AMC423162-AMC423771

United States Department of the Interior
Bureau of Land Management
 LANDS/RECREATION & PLANNING
 ONE N CENTRAL AVE
 PHOENIX, AZ 85004 -2203
 Phone: 602-417-9200

Receipt

No: 2822024

Transaction #: 2907334		ENTERED INTO COMPUTER
Date of Transaction: 06/28/2013		
CUSTOMER: JUL 10 2013 <i>pb</i>		
CONNIE HALEY PO BOX 584 GREEN VALLEY, AZ 85622 US		

LINE #	QTY	DESCRIPTION	REMARKS	UNIT PRICE	TOTAL
1	1.00	LOCATABLE MINERALS / MINING CLAIMS- NEW, UNADJUD, ONE OR MORE AUTH NOS / NEW MINING CLAIM LOCATION FEE \$34 CASES: AMC423704/\$34.00		- n/a -	34.00
2	1.00	LOCATABLE MINERALS / MINING CLAIMS- NEW, UNADJUD, ONE OR MORE AUTH NOS / NEW MINING CLAIM PROCESSING FEE \$15 CASES: AMC423704/\$15.00		- n/a -	15.00
3	1.00	LOCATABLE MINERALS / MINING CLAIMS- NEW, UNADJUD, ONE OR MORE AUTH NOS / NEW MINING CLAIM MAINT FEE \$140 CASES: AMC423704/\$140.00		- n/a -	140.00
TOTAL:					\$189.00

PAYMENT INFORMATION			
1	AMOUNT:	189.00	POSTMARKED: 06/26/2013
	TYPE:	CHECK	RECEIVED: 06/27/2013
	CHECK NO:	616	
	NAME:	HALEY, CONNIE PO BOX 584 GREEN VALLEY AZ 85622 US	

REMARKS

This receipt was generated by the automated BLM Collections and Billing System and is a paper representation of a portion of the official electronic record contained therein.

NOTICE!!

These documents have been scanned!

Do not place un-scanned documents beneath this notice!

Do not remove this notice from this file!

GPO Jacket No. 560-102
Print Order 61540
Rise Business Services, LLC
Job=AZ15 5/13/2019



Box Number= AZ15039



Claim Begin-End: AMC423704-AMC423704

2 Correspondence



AZ15039-14

AMC423162-AMC423771



United States Department of the Interior



BUREAU OF LAND MANAGEMENT
Arizona State Office
One North Central Avenue, Suite 800
Phoenix, Arizona 85004-4427
www.blm.gov/az/

OCT 30 2014

In Reply Refer To:
3800 (9310) RM
AMC418628, AMC421116, AMC421122,
AMC423063, AMC423064, AMC423704

CERTIFIED MAIL - RETURN RECEIPT REQUESTED No. 7014 0150 0000 5453 3086

NOTICE

GARY AND CONNIE HALEY : This Notice Affects Those Claims
PO BOX 584 : Shown in the Block Below.
GREEN VALLEY, AZ 85622-0584 :

AMC418628, AMC421116, AMC421122, AMC423063, AMC423064, AMC423704
PEACHIE, APACHE MOON, BUZZARDS END, HONEYCOMB, APACHE MOON 2,
SKID MARK

Affidavit of Performance of Annual Work or Notice of Intent to Hold Discrepancies

We have received your Affidavit of Performance of Annual Work (POL) or Notice of Intent to Hold (NOI) for the 2014 assessment year for the mining claims listed above. However, there was a discrepancy as noted below:

We received the POL document and processing fee. You also filed an incomplete NOI. We did not receive page 1 of the NOI nor the processing fee for the NOI. The processing fee for a NOI is \$10 per claim. In accordance with Title 43 Code of Federal Regulations (CFR) 3830.91(8) you are allowed 30 days from the date you receive this Notice (or December 30, 2014, whichever is later) to pay the additional fees. If we do not receive your payment and completed NOI within this time frame, your documents will not be recorded by BLM and your mining claims will be closed. Any non-refundable processing fees already paid will be forfeited. The NOI is the document that is required to be filed the first year you are filing a waiver. Enclosed is a NOI form for your use.

Please correct the discrepancy and submit the requested documents or fee within 30 days from your receipt of this letter. If we do not receive the correct documents or processing fee within this 30-day time frame the claims will be declared forfeited.

KDEO COMPLETED
NOI 11/17/2014. RA

If additional information is required, please contact RéAnn Myers at 602-417-9413. Please include your AMC serial number(s) on all correspondence.

Sincerely,

A handwritten signature in black ink that reads "Rebecca Heick". The signature is written in a cursive, flowing style.

Rebecca Heick
Acting Deputy State Director
Lands and Minerals Division

Enclosure

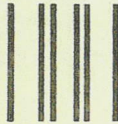

First-Class Mail
Postage & Fees Paid
USPS
Permit No. G-10

• Sender: Please print your name, address, and ZIP+4 in this box •

U.S. DEPARTMENT OF THE INTERIOR
BUREAU OF LAND MANAGEMENT
ARIZONA STATE OFFICE
ONE NORTH CENTRAL AVENUE, SUITE 800
PHOENIX, AZ 85004-4427

SENDER: COMPLETE THIS SECTION

- Complete items 1, 2, and 3. Also complete item 4 if Restricted Delivery is desired.
- Print your name and address on the reverse so that we can return the card to you.
- Attach this card to the back of the mailpiece, or on the front if space permits.

1. Article Addressed to:

GARY AND CONNIE HALEY
PO BOX 584
GREEN VALLEY, AZ 85622-0584

423063 / 423064 / 423704

AZ 931 / RM / 418628 / 42146 / 42172

2. Article Number

(Transfer from service label)

7014 0150 0000 5453 3086

COMPLETE THIS SECTION ON DELIVERY

A. Signature

X Gary Haley

Agent

Addressee

B. Received by (Printed Name)

Gary Haley

C. Date of Delivery

11-12-14

D. Is delivery address different from item 1? Yes

If YES, enter delivery address below: No

2014 NOV 13 P 2: 17

PHOENIX, ARIZONA

3. Service Type

Certified Mail®

Priority Mail Express™

Registered

Return Receipt for Merchandise

Insured Mail

Collect on Delivery

4. Restricted Delivery? (Extra Fee)

Yes

NOTICE!!

These documents have been scanned!

Do not place un-scanned documents beneath this notice!

Do not remove this notice from this file!

GPO Jacket No. 560-102
Print Order 61540
Rise Business Services, LLC
Job=AZ15 5/13/2019



Box Number= AZ15039



Claim Begin-End: AMC423704-AMC423704

3 Transfers



AZ15039-14

AMC423162-AMC423771

**NO
DOCUMENTS
FOUND**

NO DOCUMENTS FOUND
NO DOCUMENTS FOUND

NOTICE!!

These documents have been scanned!

Do not place un-scanned documents beneath this notice!

Do not remove this notice from this file!

GPO Jacket No. 560-102
Print Order 61540
Rise Business Services, LLC
Job=AZ15 5/13/2019



Box Number= AZ15039



Claim Begin-End: AMC423704-AMC423704

4 Miscellaneous



AZ15039-14

AMC423162-AMC423771

**NO
DOCUMENTS
FOUND**

NO DOCUMENTS FOUND
NO DOCUMENTS FOUND

NOTICE!!

These documents have been scanned!

Do not place un-scanned documents beneath this notice!

Do not remove this notice from this file!

GPO Jacket No. 560-102
Print Order 61540
Rise Business Services, LLC
Job=AZ15 5/13/2019



Box Number= AZ15039



Claim Begin-End: AMC423704-AMC423704

5 Annual Filings



AZ15039-14

AMC423162-AMC423771

AFFIDAVIT OF ANNUAL ASSESSMENT WORK

418628
421122
421116
423064
423063
423704

WHEN RECORDED, MAIL DOCUMENT TO:

NAME: Gary + Connie Haley
ADDRESS: PO Box 584
CITY, STATE, ZIP: Green Valley, AZ 85622

FOR COUNTY RECORDER'S USE

No. of Claims 6
x \$10/claim
Total due BLM \$ 60.00

TO ALL WHOM IT MAY CONCERN:

1. The undersigned certifies that at least \$100 per claim was expended for development, labor and improvements, or equivalent value added, as the annual assessment work for the assessment year ending September 1, 2018 for the following contiguous unpatented mining claim(s), located in the County of Pima, in the State of Arizona.

BLM Serial No.	Name of Claim	Tp	Rg	Sec	Mer	County Recordation Book and Page No.	Co. Recording Date
418628	Peachie	17 S	12 E	003	Gila & S	20123130204 page 3	11/08/2012
421122	Buzzards End	17 S	10 E	026	Gila & S	20130590127 page 2	2/28/2013
421116	Apache Moon	17 S	10 E	026	Gila & S	20130590128 page 2	2/28/2013
423064	Apache Moon 2	17 S	10 E	026	Gila & S	20131420840 page 3	5/22/2013
423063	Honeycomb	17 S	10 E	026	Gila & S	20131420839 page 3	5/22/2013
423704	Skid Mark	17 S	10 E	026	Gila & S	20132050174 page 2	7/24/2013

(Continued on page 2)

RECEIVED
BLM AZ STATE OFFICE
2018 AUG 29 P 3:02
PHOENIX, ARIZONA

#4250500

ENTERED
SEP 06 2018
BY: RAM

2. Type of labor and improvements (specify what was done and give the total value for that labor and improvement to show at least \$100 for each claim). If a geological, geochemical, or geophysical survey was performed, as per 30 U.S.C. 28-1, reference the title of the report of survey, give cost and date of the survey and report, and indicate it was filed with the County Recorder:

Description of Work Performed	Value of Work Performed	Date Work Was Performed
checked/fixe d markers, Trimed brush, Trail fix	\$ 250.	3, 19, 2018
Road work, Trash hauling, marker repair	\$ 300.	4, 2, 2018
Trimed tree's and Path improved	\$ 150.	4, 16, 2018
cleared Rock slide + Trash	\$ 400.	5, 14, 2018
Filled 3 potholes, cleared brush + trash	\$ 200.	5, 28, 2018

3. Name and mailing address of each person who performed the labor and improvements:

Name (please print)

Gary Haley
 Connie Haley

Current Mailing Address (please print)

PO Box 584, Green Valley, AZ 85622
 PO Box 584, Green Valley, AZ 85622

4. Name and mailing address of each person who holds and claims the subject mining claim(s) for the valuable minerals contained therein. Be sure to indicate if there is a change of address:

Name (please print)

Gary Haley
 Connie Haley

Current Mailing Address (please print)

PO Box 584, Green Valley, AZ 85622
 PO Box 584, Green Valley, AZ 85622

RECEIVED
 BLM AZ STATE OFFICE
 2018 AUG 29 P 3:02
 PHOENIX, ARIZONA

5. The undersigned testifies that on the date of August, 28, 2018, all monuments required by law were erected upon the subject claim(s), and all notices required by law were posted on the subject claim(s) or copies thereof were in place, and at said date, each corner monument bore or contained

markings sufficient to appropriately designate the corner of the claim to which it pertains and the name of the claim(s).

I hereby certify under penalty of perjury under the laws of the State of Arizona that the foregoing statements are true and correct:

Gary Huley; Connie Lee Huley Date: 8-27-2018
(Signature of person responsible for above statement)

Title 18 U.S.C. 1001 and 43 U.S.C. 1212 make it a crime for any person knowingly and willfully to make to any department or agency of the United States any false, fictitious or fraudulent statements or representations as to any matter within its jurisdiction.

Notary Block

SUBSCRIBED AND SWORN TO before me, this 27 day of August 20 18

By: Andrea Villa
(Signature of Affiant)

Title: Notary Public

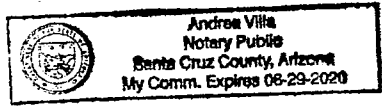

My Commission Expires: 08/29/2020

INSTRUCTIONS

1. This is an optional form that may be used to satisfy the requirements for the Bureau of Land Management (BLM) under the provisions of 43 U.S.C. §1744 and 30 U.S.C. §28-28d and the regulations thereunder (43 CFR part 3835). Since local and State laws may vary, you should contact your local and State agencies where the claims are located to ensure all applicable laws and requirements are satisfied.
2. The claimant(s) must fill in the date in paragraph 1 for the applicable assessment year and the county and state where the claims are located.
3. All claim names, BLM serial numbers, legal descriptions, and original county recording information must be listed for the claims pertaining to this assessment notice.
4. The claimant(s) must complete paragraph 2 listing all labor or improvements which was performed on or did benefit the subject mining claims. The value and date of the labor or improvements must also be listed. The total amount of labor or improvements can be listed, but the total expenditure must equal at least \$100 for each claim.
5. The names and current mailing addresses of the person(s) performing the labor shall be listed in paragraph 3.
6. The name and current mailing address of each owner (claimant) of the claims shall be listed in paragraph 4. The mailing address shall be the owner's address and not the address of an agent or anyone representing the claimant. Be sure to note if there has been a change of address.
7. Paragraph 5 shall be completed to show the date it was verified that all monuments required by law were properly erected, all notices were posted, and that corners were appropriately designated for all claims listed.
8. An exact legible reproduction or duplicate (other than microfilm or other electronic media) of this affidavit or another type of affidavit of assessment work that you file or will file in the county where each claim is located, must be filed with the BLM on or before December 30 of the calendar year in which the assessment year ends. For mill or tunnel sites, a separate notice of intent to hold must be filed with the BLM on or before December 30. Requirements for filing a notice of intent to hold can be found at 43 CFR 3835.33.
9. A processing fee of \$10 for each claim listed must be remitted to the BLM along with this or any other affidavit of assessment work.

RECEIVED
BLM AZ STATE OFFICE
PHOENIX ARIZONA
2018 AUG 29 PM 02

Gary Huley
Phone: (520) 648-2040

 Ms. Connie Haley
PO Box 584
Green Valley, AZ 85622

PLACE STICKER AT TOP OF ENVELOPE TO THE RIGHT
OF THE RETURN ADDRESS; FOLD AT DOTTED LINE

CERTIFIED MAIL



7017 1450 0001 7527 0793

  85004

U.S. POSTAGE PAID
FCM LG ENV
GREEN VALLEY, AZ
85614
AUG 27, 18
AMOUNT
\$4.66
R2304M112955-13

**UNITED STATES
DEPARTMENT OF INTERIOR**
Bureau of Land Management
Arizona State Office
One North Central Avenue, Suite 800
Phoenix, Arizona 85004-4427

RECEIVED
BLM ARIZONA STATE OFFICE
2018 AUG 29 P 3:02
PHOENIX, ARIZONA



United States Department of the Interior
Bureau of Land Management
 DIV OF LANDS, MINRLS & ENERGY
 ONE N CENTRAL AVE
 PHOENIX, AZ 85004 -4427
 Phone: 602-417-9200

Receipt

No: 4250500

Transaction #: 4366005	
Date of Transaction: 08/30/2018	
CUSTOMER:	
GARY L HALEY PO BOX 584 GREEN VALLEY, AZ 85622-0584 US	

LINE #	QTY	DESCRIPTION	REMARKS	UNIT PRICE	TOTAL
1	1.00	LOCATABLE MINERALS / MINING CLAIMS- NOT NEW-UNADJUD, ONE AUTH NO. ONLY / MINING CLAIM MONEY RECEIVED CASES: AMC418628/\$60.00	POL 2018/6 WAV	- n/a -	60.00
TOTAL:					\$60.00

PAYMENT INFORMATION			
1	AMOUNT:	60.00	POSTMARKED: N/A
	TYPE:	CHECK	RECEIVED: 08/29/2018
	CHECK NO:	1499	
	NAME:	HALEY, GARY L PO BOX 584 GREEN VALLEY AZ 85622-0584 US	

REMARKS

This receipt was generated by the automated BLM Collections and Billing System and is a paper representation of a portion of the official electronic record contained therein.

UNITED STATES
DEPARTMENT OF THE INTERIOR
BUREAU OF LAND MANAGEMENT

MAINTENANCE FEE WAIVER CERTIFICATION

SEE INSTRUCTIONS ON PAGE 2

418

AMC 418628

421122

FORM APPROVED 421116

OMB NO. 1004-0114

Expires: January 31, 2020

423064
423063

[Handwritten signature]

- This small miner waiver is filed for the assessment year beginning on September 1, ~~2017~~ and ending on September 1, ~~2018~~ 19.
- The undersigned and all related parties owned ten or fewer mining claims, mill, or tunnel sites located and maintained on Federal lands in the United States of America on September 1, 2018.
- The undersigned have performed the assessment work required by law for each mining claim listed prior to filing this waiver and understand that by filing this form, the undersigned must file an affidavit of assessment work with the Bureau of Land Management (BLM) by the December 30th following the filing of this waiver.
- The undersigned understand that if the assessment work obligation has not yet come due under 30 U.S.C. 28 (for those claims in their first assessment year only), a notice of intent to hold reciting this condition must be recorded by the December 30th following the filing of this waiver.
- The undersigned understand that mill and tunnel sites may also be listed on this waiver and be waived from payment of the maintenance fee, and that a notice of intent to hold for these sites is required to be filed with the BLM by the December 30th following the filing of this waiver.
- The undersigned understand and acknowledge that pursuant to 43 U.S.C. 1212 and 18 U.S.C. 1001, the filing or recording of a false, fictitious, or fraudulent document with the BLM may result in a fine of up to \$250,000, a prison term not to exceed five years, or both.
- The mining claims, mill or tunnel sites for which this waiver from payment of the maintenance fees is requested are:

423704

CLAIM OR SITE NAME	BLM RECORDATION SERIAL NUMBER
1. Peachie	418628 (913)
2. Buzzards End	421122
3. Apache Moon	421116
4. Apache Moon 2	423064
5. Honeycomb	423063
6. Skidmark	423704
7.	
8.	
9.	
10.	

The owner(s) (claimants) of the above mining claims and sites are:

Connie Haley (Owner's Name - Please Print) *Connie Lee Haley* (Owner's Signature)
 PO Box 584, Green Valley, AZ 85622 (Owner's Mailing Address) Green Valley (City) AZ (State) 85622 (Zip Code)

Gary Haley (Owner's Name - Please Print) *Gary Haley* (Owner's Signature)
 PO Box 584, Green Valley, AZ 85622 (Owner's Mailing Address) Green Valley (City) AZ (State) 85622 (Zip Code)

_____ (Owner's Name - Please Print) _____ (Owner's Signature)
 _____ (Owner's Mailing Address) _____ (City) _____ (State) _____ (Zip Code)

_____ (Owner's Name - Please Print) _____ (Owner's Signature)
 _____ (Owner's Mailing Address) _____ (City) _____ (State) _____ (Zip Code)

RECEIVED
BLM AZ STATE OFFICE
PHOENIX, ARIZONA
2018 AUG 29 3:02

(Continued on page 2)

483
ENTERED
SEP 10 2018
BY: *[Signature]*

nws

Connie Haley

(Owner's Name - Please Print)

PO Box 584

(Owner's Mailing Address)

X Connie L. Haley

(Owner's Signature)

Green Valley

(City)

AZ

(State)

85622

(Zip Code)

Gary Haley

(Owner's Name - Please Print)

PO Box 584

(Owner's Mailing Address)

X Gary Haley

(Owner's Signature)

Green Valley

(City)

AZ

(State)

85622

(Zip Code)

(Owner's Name - Please Print)

(Owner's Signature)

(Owner's Mailing Address)

(City)

(State)

(Zip Code)

(Owner's Name - Please Print)

(Owner's Signature)

(Owner's Mailing Address)

(City)

(State)

(Zip Code)

18 U.S.C. 1001 and 43 U.S.C. 1212 make it a crime for any person knowingly and willfully to make to any department or agency of the United States any false, fictitious or fraudulent statements or representations as to any matter within its jurisdiction.

INSTRUCTIONS

1. This certification is made under the provisions of 43 U.S.C. § 1744 and 30 U.S.C. §28-28k and the regulations thereunder (43 CFR Part 3830).
2. The claimant(s) must fill in the dates in paragraph 1 for the beginning and ending of the assessment year for which this waiver is sought.
3. The claimant(s) must fill in the date in paragraph 2 for the beginning of the assessment year for which this waiver is sought.
4. All claim and site names and BLM serial numbers must be listed for the mining claims, mill sites, and tunnel sites for which the waiver is sought.
5. All owners of the mining claims, mill sites, and tunnel sites and their addresses must be given.
6. This waiver form must be signed by all the claimants or their designated agent, in original form. If an agent is designated, a notarized designation of agent, signed by all of the claimants with proper address given, must be submitted with this waiver.
7. This form must be filed no later than September 1st for the upcoming assessment year in the BLM State Office where the mining claims or sites are recorded, or the waiver cannot be granted by the BLM. (Example: To obtain a waiver for the assessment year 2012, which begins on September 1, 2011, you must qualify for and file for a waiver no later than September 1, 2011, in the proper BLM State Office.)
8. For all mining claims which require assessment work, you must record an affidavit of labor on or before the December 30th immediately following the filing of this waiver. For all other mining claims or sites waived, you must record a notice of intent to hold on or before the December 30th immediately following the filing of this waiver.
9. Mill and tunnel sites may also be listed on this waiver and be waived from payment of the maintenance fee. A notice of intent to hold for these sites is required to be filed by the December 30th following the filing of this waiver.

RECEIVED
BLM ARIZONA STATE OFFICE
2010 AUG 29 P 3:02
PHOENIX, ARIZONA

FOR OFFICIAL USE ONLY

(Continued on page 3)

(Form 3830-2, page 2)

Gary Haley

Phone (520) 648-2040

Amc 418628
 421116
 421122
 423063
 423064
 423704

429
 JMC

Print

Clear

Form 3330-2
 (January 2017)

UNITED STATES
 DEPARTMENT OF THE INTERIOR
 BUREAU OF LAND MANAGEMENT

MAINTENANCE FEE WAIVER CERTIFICATION

FORM APPROVED
 OMB NO. 1004-0114
 Expires: January 31, 2020

SEE INSTRUCTIONS ON PAGE 2

- This small miner waiver is filed for the assessment year beginning on September 1, ~~2016~~ ²⁰¹⁷ and ending on September 1, ~~2017~~ ²⁰¹⁸.
- The undersigned and all related parties owned ten or fewer mining claims, mill, or tunnel sites located and maintained on Federal lands in the United States of America on September 1, ~~2017~~ ²⁰¹⁷.
- The undersigned have performed the assessment work required by law for each mining claim listed prior to filing this waiver and understand that by filing this form, the undersigned must file an affidavit of assessment work with the Bureau of Land Management (BLM) by the December 30th following the filing of this waiver.
- The undersigned understand that if the assessment work obligation has not yet come due under 30 U.S.C. 28 (for those claims in their first assessment year only), a notice of intent to hold reciting this condition must be recorded by the December 30th following the filing of this waiver.
- The undersigned understand that mill and tunnel sites may also be listed on this waiver and be waived from payment of the maintenance fee, and that a notice of intent to hold for these sites is required to be filed with the BLM by the December 30th following the filing of this waiver.
- The undersigned understand and acknowledge that pursuant to 43 U.S.C. 1212 and 18 U.S.C. 1001, the filing or recording of a false, fictitious, or fraudulent document with the BLM may result in a fine of up to \$250,000, a prison term not to exceed five years, or both.
- The mining claims, mill or tunnel sites for which this waiver from payment of the maintenance fees is requested are:

CLAIM OR SITE NAME	BLM RECORDATION SERIAL NUMBER
1. Peachie	✓ 418628
2. Buzzards End	421122
3. Apache Moon	421116
4. Apache moon 2	423064
5. Honeycomb	423063
6. Skid Mark	423704
7.	
8.	
9.	
10.	

The owner(s) (claimant) of the above mining claims and sites are:

Connie Haley
 (Owner's Name - Please Print)
 PO Box 584, Green Valley, AZ 85622
 (Owner's Mailing Address)

X Connie Lee Haley
 (Owner's Signature)
 Green Valley AZ 85622
 (City) (State) (Zip Code)

Gary Haley
 (Owner's Name - Please Print)
 PO Box 584, Green Valley, AZ 85622
 (Owner's Mailing Address)

X Gary Haley
 (Owner's Signature)
 Green Valley AZ 85622
 (City) (State) (Zip Code)

(Owner's Name - Please Print)

(Owner's Mailing Address)

(Owner's Name - Please Print)

(Owner's Mailing Address)

(Owner's Signature)

(City)

(Owner's Signature)

(City)

(Continued on page 2)

RECEIVED
 BLM STATE OFFICE
 2017 AUG 23 A 7:51
 PHOENIX, ARIZONA

INTEREST
 SEP 12 2017
 BY: JMC

NWC

Connie Haley
(Owner's Name - Please Print)
PO Box 584
(Owner's Mailing Address)

X Connie Lee Haley
(Owner's Signature)
Green Valley AZ 85622
(City) (State) (Zip Code)

Gary Haley
(Owner's Name - Please Print)
Po Box 584
(Owner's Mailing Address)

X Gary Haley
(Owner's Signature)
Green Valley AZ 85622
(City) (State) (Zip Code)

(Owner's Name - Please Print)
(Owner's Mailing Address)

(Owner's Signature)
(City) (State) (Zip Code)

(Owner's Name - Please Print)
(Owner's Mailing Address)

(Owner's Signature)
(City) (State) (Zip Code)

18 U.S.C. 1001 and 43 U.S.C. 1211 make it a crime for any person knowingly and willfully to make to any department or agency of the United States any false, fictitious or fraudulent statements or representations as to any matter within its jurisdiction.

INSTRUCTIONS

1. This certification is made under the provisions of 43 U.S.C. § 1744 and 30 U.S.C. §28-28k and the regulations thereunder (43 CFR Part 3830).
2. The claimant(s) must fill in the dates in paragraph 1 for the beginning and ending of the assessment year for which this waiver is sought.
3. The claimant(s) must fill in the date in paragraph 2 for the beginning of the assessment year for which this waiver is sought.
4. All claim and site names and BLM serial numbers must be listed for the mining claims, mill sites, and tunnel sites for which the waiver is sought.
5. All owners of the mining claims, mill sites, and tunnel sites and their addresses must be given.
6. This waiver form must be signed by all the claimants or their designated agent, in original form. If an agent is designated, a notarized designation of agent, signed by all of the claimants with proper address given, must be submitted with this waiver.
7. This form must be filed no later than September 1st for the upcoming assessment year in the BLM State Office where the mining claims or sites are recorded, or the waiver cannot be granted by the BLM. (Example: To obtain a waiver for the assessment year 2012, which begins on September 1, 2011, you must qualify for and file for a waiver no later than September 1, 2011, in the proper BLM State Office.)
8. For all mining claims which require assessment work, you must record an affidavit of labor on or before the December 30th immediately following the filing of this waiver. For all other mining claims or sites waived, you must record a notice of intent to hold on or before the December 30th immediately following the filing of this waiver.
9. Mill and tunnel sites may also be listed on this waiver and be waived from payment of the maintenance fee. A notice of intent to hold for these sites is required to be filed by the December 30th following the filing of this waiver.

PHOENIX, ARIZONA
2011 AUG 23 A 7:51
RECEIVED
BLM AZ STATE OFFICE
FOR OFFICIAL USE ONLY
Form 3820-1 (page 2)

(Continued on page 3)

Gary Haley
Phone # (520) 648-2040

418628
 421122
 421116
 423064
 423063

423704

Form 3830-4
 (January 2017)

UNITED STATES
 DEPARTMENT OF THE INTERIOR
 BUREAU OF LAND MANAGEMENT

FORM APPROVED
 OMB NO.: 1004-0114
 Expires: January 31, 2020

AFFIDAVIT OF ANNUAL ASSESSMENT WORK

WHEN RECORDED, MAIL DOCUMENT TO:

NAME: Gary + Connie Haley
 ADDRESS: Po Box 584
 CITY, STATE, ZIP: Green Valley, AZ 85622

FOR COUNTY RECORDER'S USE

No. of Claims 6
 x \$10/claim
 Total due BLM \$ 60.00

TO ALL WHOM IT MAY CONCERN:

1. The undersigned certifies that at least \$100 per claim was expended for development, labor and improvements, or equivalent value added, as the annual assessment work for the assessment year ending September 1, 2017 for the following contiguous unpatented mining claim(s), located in the County of Pima in the State of Arizona.

BLM Serial No.	Name of Claim	Tp	Rg	Sec	Mer	County Recordation Book and Page No.	Date
418628	Peachie	17 S	12 E	003	Gila & S	20123130204 page 3	11/08/2012
421122	Buzzards End	17 S	10 E	026	Gila & S	20130590127 page 2	2/28/2013
421116	Apache Moon	17 S	10 E	026	Gila & S	20130590128 page 2	2/28/2013
423064	Apache Moon 2	17 S	10 E	026	Gila & S	20131420840 page 3	5/22/2013
423063	Honeycomb	17 S	10 E	026	Gila & S	20131420839 page 3	5/22/2013
423704	Skid Mark	17 S	10 E	026	Gila & S	20132050174 page 2	7/24/2013

(Continued on page 2)

3954860

ENTERED
 AUG 29 2017
 BY: R Am

RECEIVED
 BLM AZ STATE OFFICE
 2017 AUG 23 A 7:51
 PUEBLO, ARIZONA

2. Type of labor and improvements (specify what was done and give the total value for that labor and improvement to show at least \$100 for each claim). If a geological, geochemical, or geophysical survey was performed, as per 30 U.S.C. 28-1, reference the title of the report of survey, give cost and date of the survey and report, and indicate it was filed with the County Recorder:

Description of Work Performed	Value of Work Performed	Date Work Was Performed
Filled potholes, Cleared brush, Removed trash	\$400.	3, 20, 17
Checked + fixed claim markers, Removed trash	\$150.	4, 16, 17
Improved Path, fixed markers	\$175.	4, 24, 17
Trimmed trees, Cleared trash	\$200.	5, 15, 17
Moved Rocks from Road, Removed trash, Markers	\$250.	5, 29, 17

3. Name and mailing address of each person who performed the labor and improvements:

Name (please print)

Gary Haley
 Connie Haley

Current Mailing Address (please print)

PO BOX 584, Green Valley, AZ 85622
 PO BOX 584, Green Valley, AZ 85622

4. Name and mailing address of each person who holds and claims the subject mining claim(s) for the valuable minerals contained therein. Be sure to indicate if there is a change of address:

Name (please print)

Gary Haley
 Connie Haley

Current Mailing Address (please print)

PO BOX 584, Green Valley, AZ 85622
 PO BOX 584, Green Valley, AZ 85622

5. The undersigned testifies that on the date of August 22, 2017, all monuments required by law were erected upon the subject claim(s), and all notices required by law were posted on the subject claim(s) or copies thereof were in place, and at said date, each corner monument bore the following:

(Continued on page 3)

RECEIVED
 STATE OFFICE
 AUG 23 A 7:52
 PHOENIX, ARIZONA

markings sufficient to appropriately designate the corner of the claim to which it pertains and the name of the claim(s).

I hereby certify under penalty of perjury under the laws of the State of Arizona that the foregoing statements are true and correct.

Gary L. Haley Date: 8-21-2017
(Signature of person responsible for above statement)

Title 18 U.S.C. 1001 and 43 U.S.C. 1212 make it a crime for any person knowingly and willfully to make to any department or agency of the United States any false, fictitious or fraudulent statements or representations as to any matter within its jurisdiction.

Notary Block

SUBSCRIBED AND SWORN TO before me, this 21st day of August 2017

By: Rose Mendoza
(Signature of Affiant)

Title: NOTARY

My Commission Expires: OCT. 28, 2018

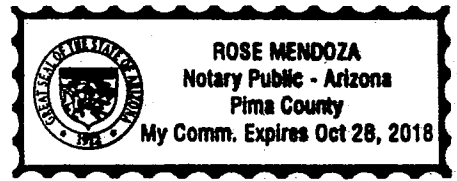

INSTRUCTIONS

1. This is an optional form that may be used to satisfy the requirements for the Bureau of Land Management (BLM) under the provisions of 43 U.S.C. §1744 and 30 U.S.C. §28-28d and the regulations thereunder (43 CFR part 3835). Since local and State laws may vary, you should contact your local and State agencies where the claims are located to ensure all applicable laws and requirements are satisfied.
2. The claimant(s) must fill in the date in paragraph 1 for the applicable assessment year and the county and state where the claims are located.
3. All claim names, BLM serial numbers, legal descriptions, and original county recording information must be listed for the claims pertaining to this assessment notice.
4. The claimant(s) must complete paragraph 2 listing all labor or improvements which was performed on or did benefit the subject mining claims. The value and date of the labor or improvements must also be listed. The total amount of labor or improvements can be listed, but the total expenditure must equal at least \$100 for each claim.
5. The names and current mailing addresses of the person(s) performing the labor shall be listed in paragraph 3.
6. The name and current mailing address of each owner (claimant) of the claims shall be listed in paragraph 4. The mailing address shall be the owner's address and not the address of an agent or anyone representing the claimant. Be sure to note if there has been a change of address.
7. Paragraph 5 shall be completed to show the date it was verified that all monuments required by law were properly erected, all notices were posted, and that corners were appropriately designated for all claims listed.
8. An exact legible reproduction or duplicate (other than microfilm or other electronic media) of this affidavit or another type of affidavit of assessment work that you file or will file in the county where each claim is located must be filed with the BLM on or before December 30 of the calendar year in which the assessment year ends. For mill or tunnel sites, a separate notice of intent to hold must be filed with the BLM on or before December 30. Requirements for filing a notice of intent to hold can be found at 43 CFR 3835.33.
9. A processing fee of \$10 for each claim listed must be remitted to the BLM along with this or another affidavit of assessment work.

(Continued on page 4)

RECEIVED
BLM STATE OFFICE
SEP 23 11 52
TUCSON, ARIZONA

Gary Haley
Phone #(520) 648-2040

Connie & Gary Haley
PO Box 584
Green Valley, AZ 85622



1006



85004

U.S. POSTAGE
PAID
SAHUARITA, AZ
85629
AUG 21 17
AMOUNT
\$6.65
R2304H109228-07

Expected Delivery Day: 08/23/2017

USPS TRACKING NUMBER



9505 5123 7573 7233 1981 37

UNITED STATES
DEPARTMENT OF INTERIOR
Bureau of Land Management
Arizona State Office
One North Central Avenue, Suite 800
Phoenix, Arizona 85004-4427

RECEIVED
BLM
DEPT OF
INTERIOR
PHOENIX, ARIZONA
2017 AUG 23 A 1 51



United States Department of the Interior
Bureau of Land Management
 DIV OF LANDS, MINRLS & ENERGY
 ONE N CENTRAL AVE
 PHOENIX, AZ 85004 -4427
 Phone: 602-417-9200

Receipt

No: 3954860

Transaction #: 4064624	
Date of Transaction: 08/24/2017	
CUSTOMER:	
CONNIE HALEY PO BOX 584 GREEN VALLEY, AZ 85622 US	

LINE #	QTY	DESCRIPTION	REMARKS	UNIT PRICE	TOTAL
1	1.00	LOCATABLE MINERALS / MINING CLAIMS- NOT NEW-UNADJUD, ONE AUTH NO. ONLY / MINING CLAIM MONEY RECEIVED CASES: AMC418628/\$60.00	MAINT 2018/6 WAV	- n/a -	60.00
TOTAL:					\$60.00

PAYMENT INFORMATION					
1	AMOUNT:	60.00	POSTMARKED:	08/21/2017	
	TYPE:	CHECK	RECEIVED:	08/23/2017	
	CHECK NO:	1320			
	NAME:	HALEY, CONNIE L PO BOX 584 GREEN VALLEY AZ 85622 US			

REMARKS

This receipt was generated by the automated BLM Collections and Billing System and is a paper representation of a portion of the official electronic record contained therein.

UNITED STATES
DEPARTMENT OF THE INTERIOR
BUREAU OF LAND MANAGEMENT

FORM APPROVED 418628
OMB NO.: 1004-0114
Expires: October 31, 2016
421122
421116

AFFIDAVIT OF ANNUAL ASSESSMENT WORK

WHEN RECORDED, MAIL DOCUMENT TO:

NAME: Gary + Connie Haley

ADDRESS: PO Box 584

CITY, STATE, ZIP: Green Valley, AZ 85622

423064

423063

423704

FOR COUNTY RECORDER'S USE

No. of Claims 6
x \$10/claim
Total due BLM \$ 60.00

TO ALL WHOM IT MAY CONCERN:

1. The undersigned certifies that at least \$100 per claim was expended for development, labor and improvements, or equivalent value added, as the annual assessment work for the assessment year ending September 1, 2016 for the following contiguous unpatented mining claim(s), located in the County of Pima, in the State of Arizona.

BLM Serial No.	Name of Claim	Tp	Rg	Sec	Mer	County Recordation Book and Page No.	Date
418628	Peachie	17 S	12 E	003	Gila & S	20123130204 page 3	11/08/2012
421122	Buzzards End	17 S	10 E	026	Gila & S	20130590127 page 2	2/28/2013
421116	Apache Moon	17 S	10 E	026	Gila & S	20130590128 page 2	2/28/2013
423064	Apache Moon 2	17 S	10 E	026	Gila & S	20131420840 page 3	5/22/2013
423063	Honeycomb	17 S	10 E	026	Gila & S	20131420839 page 3	5/22/2013
423704	Skid Mark	17 S	10 E	026	Gila & S	20132050174 page 2	7/24/2013

RECEIVED
BLM AZ STATE OFFICE
PHOENIX, ARIZONA
21th AUG 25 P 2:18

(Continued on page 2)

AUG 29 2016
BY: R am

RECEIPT # 3642474

2. Type of labor and improvements (specify what was done and give the total value for that labor and improvement to show at least \$100 for each claim). If a geological, geochemical, or geophysical survey was performed, as per 30 U.S.C. 28-1, reference the title of the report of survey, give cost and date of the survey and report, and indicate it was filed with the County Recorder:

Description of Work Performed	Value of Work Performed	Date Work Was Performed
Improved roads, removed trash, cut brush	\$ 250.	March, 14, 15
Checked + fixed claim markers, cleared brush, trash	\$ 150.	March, 21, 15
Levelled roads, removed rocks	\$ 400.	April, 11, 15
fixed potholes, Trash removal	\$ 250.	May, 9, 15
Removed brush, filled potholes for access.	\$ 200.	May, 23, 15

3. Name and mailing address of each person who performed the labor and improvements:

Name (please print)

Gary Haley
 Connie Haley

Current Mailing Address (please print)

PO Box 584, Green Valley, AZ 85622
 PO Box 584, Green Valley, AZ 85622

4. Name and mailing address of each person who holds and claims the subject mining claim(s) for the valuable minerals contained therein. Be sure to indicate if there is a change of address:

Name (please print)

Gary Haley
 Connie Haley

Current Mailing Address (please print)

PO Box 584, Green Valley 85622
 PO Box 584, Green Valley 85622

RECEIVED
 BLM AZ STATE OFFICE
 2016 AUG 25 P 2:18
 PHOENIX, ARIZONA

5. The undersigned testifies that on the date of August, 23, 2016, all monuments required by law were erected upon the subject claim(s), and all notices required by law were posted on the subject claim(s) or copies thereof were in place, and at said date, each corner monument bore or contained

2016 AUG 25 P 2:18

PHOENIX, ARIZONA

markings sufficient to appropriately designate the corner of the claim to which it pertains and the name of the claim(s).

I hereby certify under penalty of perjury under the laws of the State of Arizona that the foregoing statements are true and correct:

X Comie L. Haley / Mary Haley Date: 8-23-2016
(Signature of person responsible for above statement)

Title 18 U.S.C. 1001 and 43 U.S.C. 1212 make it a crime for any person knowingly and willfully to make to any department or agency of the United States any false, fictitious or fraudulent statements or representations as to any matter within its jurisdiction.

Notary Block

SUBSCRIBED AND SWORN TO before me, this 23rd day of August 202016

By: [Signature]
(Signature of Affiant)

Title: Branch Mgr

My Commission Expires: 1-2-2020

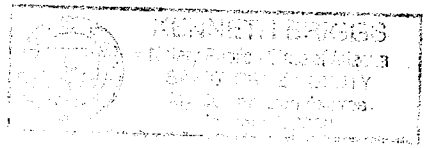

INSTRUCTIONS

1. This is an optional form that may be used to satisfy the requirements for the Bureau of Land Management (BLM) under the provisions of 43 U.S.C. §1744 and 30 U.S.C. §28-28d and the regulations thereunder (43 CFR part 3835). Since local and State laws may vary, you should contact your local and State agencies where the claims are located to ensure all applicable laws and requirements are satisfied.
2. The claimant(s) must fill in the date in paragraph 1 for the applicable assessment year and the county and state where the claims are located.
3. All claim names, BLM serial numbers, legal descriptions, and original county recording information must be listed for the claims pertaining to this assessment notice.
4. The claimant(s) must complete paragraph 2 listing all labor or improvements which was performed on or did benefit the subject mining claims. The value and date of the labor or improvements must also be listed. The total amount of labor or improvements can be listed, but the total expenditure must equal at least \$100 for each claim.
5. The names and current mailing addresses of the person(s) performing the labor shall be listed in paragraph 3.
6. The name and current mailing address of each owner (claimant) of the claims shall be listed in paragraph 4. The mailing address shall be the owner's address and not the address of an agent or anyone representing the claimant. Be sure to note if there has been a change of address.
7. Paragraph 5 shall be completed to show the date it was verified that all monuments required by law were properly erected, all notices were posted, and that corners were appropriately designated for all claims listed.
8. An exact legible reproduction or duplicate (other than microfilm or other electronic media) of this affidavit or another type of affidavit of assessment work that you file or will file in the county where each claim is located, must be filed with the BLM on or before December 30 of the calendar year in which the assessment year ends. For mill or tunnel sites, a separate notice of intent to hold must be filed with the BLM on or before December 30. Requirements for filing a notice of intent to hold can be found at 43 CFR 3835.33.
9. A processing fee of \$10 for each claim listed must be remitted to the BLM along with this or any other affidavit of assessment work.

NOTICE OF INTENTION TO HOLD MINING CLAIMS/SITES

When Recorded Return Document to:

Gary + Connie Haley
PO Box 584
Green Valley, AZ 85622

RECEIVED
 BLM AZ STATE OFFICE
 2016 AUG 25 P 2:18
 PHOENIX, ARIZONA
 BLM
 Date
 Stamp

8/30/16
 8:33A... I called and
 left a msg.

Check here if this is a change of address.

Telephone: (520) 648-2040

E-mail Address: adamsplace773@peoplepc.com

I (We) intend to hold the claims(s) and/or site(s) listed below for the calendar year 2017, and I (We) have filed or will file a Notice of Intent to Hold in the county where the claim (s) is located.

Reason for filing a Notice of Intent to Hold instead of an assessment work filing (check one):

- Maintenance fee was paid to maintain claim(s) during this assessment year.
- Mill or tunnel sites.
- Claim(s) was located during the current assessment year.
- BLM has deferred assessment work (attach copy of decision granting deferment, or pending petition for deferment including date petition was filed.)

Line No.	AMC NUMBER	CLAIM/SITE NAME	COUNTY RECORDER DATA (if available)	TWP	RNG	SEC
1	418628	Peachie	20123130204	17S	12E	003
2	421122	Buzzards End	20130590127	17S	10E	026
3	421116	Apache Moon	20130590128	17S	10E	026
4	423064	Apache Moon 2	20131420840	17S	10E	026
5	423063	Honey Comb	20131420839	17S	10E	026
6	423704	Skid Mark	20132050174	17S	10E	026
7						
8						
9						
10						

Form: MCF110

Revised July 2014

Page 1 of 2

This NOI Form is OPTIONAL; the above claims have been under a Waiver since 2015. PB

1/30/16 (3:14pm) Mr. Haley called - stated if the NOI is not necessary, please disregard it, he will send his request via EMAIL as well. Email MSG Rec'd on 8/30/16 @ 3:43pm (Attached). PB

NOTICE OF INTENTION TO HOLD MINING CLAIMS/SITES
page 2

RECEIVED
BLM AZ STATE OFFICE
2016 AUG 25 P 2:18
PHOENIX, ARIZONA
BLM
Date
Stamp

1. State of Arizona, County of Pima

2. I (Name) Connie Haley, Gary Haley

3. Reside at (Address) 16621 Horse Hollow Trail

City Sahuarita County Pima State AZ Zip 85629 being duly sworn, depose and say that I am a citizen of the United States, more than eighteen years of age, that all of the facts set forth in this notice, subject to the provisions and penalties of 18 U.S.C. 1001 pertaining to the filing of false, fictitious, or fraudulent statements with the United States, are true and correct according to the best of my knowledge, information and belief.

4. Owner's name and address (If not shown in Items 1-3 above). Connie Haley + Gary Haley

5. Dated: 8/23/2016 Signature: Connie L. Haley, Gary Haley

Bureau of Land Management
Arizona State Office
www.blm.gov/az

No. of Claims: _____ x \$10 = _____
Check No: _____ Init. _____
Receipt No.: _____
For BLM Use Only



Brown, Pauline <paulinebrown@blm.gov>

AMC418628, ET AL

1 message

Brown, Pauline <paulinebrown@blm.gov>
To: adamsplace773@peoplec.com

Tue, Aug 30, 2016 at 9:39 AM

To Gary and Connie Haley,

On August 25, 2016, this office received a payment for \$60 (Receipt #3642474); with the payment, you submitted a Notice of intention (NOI) to hold mining claims form (Form: MCF110) and the Affidavit of annual assessment work (POL) form (Form 3830-4).

For your information, the \$60 payment was applied towards the assessment work on the 6 claims you listed on the POL form. The NOI form is 'optional' at this time because you have been filing a waiver on the same 6 claims since 2015.

If you still want us to process the NOI form, you will need to send in an additional \$60 because the fee to process the NOI is \$10 per mining claim. If you have any questions please feel free to call.

Regards,

—
PAULINE BROWN
LAND LAW EXAMINER
BUREAU OF LAND MANAGEMENT
ARIZONA STATE OFFICE
ONE NORTH CENTRAL AVE, STE 800
PHOENIX, AZ 85004-4427
OFFICE: (602) 417-9360
FAX: (602) 417-9490; 602-417-9452
paulinebrown@blm.gov
www.blm.gov/az
<https://www.facebook.com/BLMArizona>



Connie Agency
 PO Box 584
 Green Valley, AZ 85622-0584

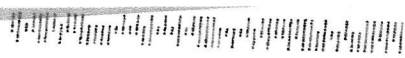

7015 3430 0001 0100 1387



1000



85004

U.S. POSTAGE
 PAID
 GREEN VALLEY, AZ
 85614
 AUG 23, 16
 AMOUNT
\$4.45
 R2303S101109-13

RECEIVED
 BLM AZ STATE OFFICE
 2016 AUG 25 P 2:17
 PHOENIX, ARIZONA

**UNITED STATES
 DEPARTMENT OF INTERIOR
 Bureau of Land Management
 Arizona State Office
 One North Central Avenue, Suite 800
 Phoenix, Arizona 85004-4427**

Customer Name Update Screen

System ID:MC

Name:

Proprietor #:

Renumber To:

Category:

Address:

City:

State:

Zip:

UNDELIVERABLE

Email:

Phone:

ENTERED AUG 30 2016

*Email / ph
fb*

Customer details successfully saved for Customer Id 2336331

Customer Name Update Screen

System ID:MC

Name:

Proprietor #:

Renumber To:

Category:

Address:

City:

State:

Zip:

UNDELIVERABLE

Email:

Phone:

ENTERED AUG 30 2016

PS

Customer details successfully saved for Customer Id 2336330

United States Department of the Interior
Bureau of Land Management
 DIV OF LANDS, MINRLS & ENERGY
 ONE N CENTRAL AVE
 PHOENIX, AZ 85004 -4427
 Phone: 602-417-9200

Receipt

No: 3642474

Transaction #: 3746430	
Date of Transaction: 08/26/2016	
CUSTOMER:	
CONNIE HALEY PO BOX 584 GREEN VALLEY, AZ 85622 US	

LINE #	QTY	DESCRIPTION	REMARKS	UNIT PRICE	TOTAL
1	1.00	LOCATABLE MINERALS / MINING CLAIMS- NOT NEW-UNADJUD, ONE AUTH NO. ONLY / MINING CLAIM MONEY RECEIVED CASES: AMC418628/\$60.00	NOI/POL 2016 - 6 <i>optional</i>	- n/a -	60.00
TOTAL:					\$60.00

PAYMENT INFORMATION					
1	AMOUNT:	60.00	POSTMARKED:	08/23/2016	
	TYPE:	CHECK	RECEIVED:	08/25/2016	
	CHECK NO:	1136			
	NAME:	HALEY, CONNIE L PO BOX 584 GREEN VALLEY AZ 85622 US			

REMARKS

This receipt was generated by the automated BLM Collections and Billing System and is a paper representation of a portion of the official electronic record contained therein.



AMC418628, ET AL

4 messages

Brown, Pauline <paulinebrown@blm.gov>
To: adamsplace773@peoplec.com

Tue, Aug 30, 2016 at 9:39 AM

To Gary and Connie Haley,

On August 25, 2016, this office received a payment for \$60 (Receipt #3642474); with the payment, you submitted a Notice of interntion (NOI) to hold mining claims form (Form: MCF110) and the Affidavit of annual assessment work (POL) form (Form 3830-4).

For your information, the \$60 payment was applied towards the assessment work on the 6 claims you listed on the POL form. The NOI form is 'optional' at this time because you have been filing a waiver on the same 6 claims since 2015.

If you still want us to process the NOI form, you will need to send in an additional \$60 because the fee to process the NOI is \$10 per mining claim. If you have any questions please feel free to call.

Regards,

—
PAULINE BROWN
LAND LAW EXAMINER
BUREAU OF LAND MANAGEMENT
ARIZONA STATE OFFICE
ONE NORTH CENTRAL AVE, STE 800
PHOENIX, AZ 85004-4427
OFFICE: (602) 417-9360
FAX: (602) 417-9490; 602-417-9452
paulinebrown@blm.gov
www.blm.gov/az
https://www.facebook.com/BLMArizona

Brown, Pauline <paulinebrown@blm.gov>
To: adamsplace773@peoplepc.com

Tue, Aug 30, 2016 at 3:27 PM

Sorry, I forgot the p in the message sent today at 9:39am.
Thank you for returning my call.

Regards,

—— Forwarded message ——
From: **Brown, Pauline** <paulinebrown@blm.gov>
Date: Tue, Aug 30, 2016 at 9:39 AM
Subject: AMC418628, ET AL
To: adamsplace773@peoplec.com

To Gary and Connie Haley,

On August 25, 2016, this office received a payment for \$60 (Receipt #3642474); with the payment, you submitted a Notice of interntion (NOI) to hold mining claims form (Form: MCF110) and the Affidavit of annual assessment work (POL) form (Form 3830-4).

For your information, the \$60 payment was applied towards the assessment work on the 6 claims you listed on the POL form. The NOI form is 'optional' at this time because you have been filing a waiver on the same 6 claims since 2015.

If you still want us to process the NOI form, you will need to send in an additional \$60 because the fee to process the NOI is \$10 per mining claim. If you have any questions please feel free to call.

Regards,

PAULINE BROWN
LAND LAW EXAMINER
BUREAU OF LAND MANAGEMENT
ARIZONA STATE OFFICE
ONE NORTH CENTRAL AVE, STE 800
PHOENIX, AZ 85004-4427
OFFICE: (602) 417-9360
FAX: (602) 417-9490; 602-417-9452
paulinebrown@blm.gov
www.blm.gov/az
https://www.facebook.com/BLMArizona

PAULINE BROWN
LAND LAW EXAMINER
BUREAU OF LAND MANAGEMENT
ARIZONA STATE OFFICE
ONE NORTH CENTRAL AVE, STE 800
PHOENIX, AZ 85004-4427
OFFICE: (602) 417-9360
FAX: (602) 417-9490; 602-417-9452
paulinebrown@blm.gov
www.blm.gov/az
https://www.facebook.com/BLMArizona

Sender A <adamsplace773@peoplepc.com>
Reply-To: Sender A <adamsplace773@peoplepc.com>
To: "Brown, Pauline" <paulinebrown@blm.gov>

Tue, Aug 30, 2016 at 3:36 PM

Dear Pauline Brown,

I'm writing to confirm please DO NOT process the "Notice Of Intent form" that was incorrectly added with Affidavit of assessment work forms.

Thank you for all your assistance, Gary Haley

—Original Message—

From: "Brown, Pauline"
Sent: Aug 30, 2016 3:27 PM
To: adamsplace773@peoplepc.com
Subject: Fwd: AMC418628, ET AL

Sorry, I forgot the p in the message sent today at 9:39am.
Thank you for returning my call.

Regards,

— Forwarded message —
From: **Brown, Pauline** <paulinebrown@blm.gov>
Date: Tue, Aug 30, 2016 at 9:39 AM
Subject: AMC418628, ET AL
To: adamsplace773@peoplepc.com

To Gary and Connie Haley,

On August 25, 2016, this office received a payment for \$60 (Receipt #3642474); with the payment, you submitted a Notice of interntion (NOI) to hold mining claims form (Form: MCF110) and the Affidavit of annual assessment work (POL) form (Form 3830-4).

For your information, the \$60 payment was applied towards the assessment work on the claims you listed on the POL form. The NOI form is 'optional' at this time because you have been filing a waiver of the same 6 claims since 2015.

If you still want us to process the NOI form, you will need to send in an additional \$60 because the fee to process the NOI is \$10 per mining claim. If you have any questions please feel free to call.

Regards,

—
PAULINE BROWN
LAND LAW EXAMINER
BUREAU OF LAND MANAGEMENT
ARIZONA STATE OFFICE
ONE NORTH CENTRAL AVE, STE 800
PHOENIX, AZ 85004-4427
OFFICE: (602) 417-9360
FAX: (602) 417-9490; 602-417-9452
paulinebrown@blm.gov
www.blm.gov/az
https://www.facebook.com/BLMArizona

—
PAULINE BROWN
LAND LAW EXAMINER
BUREAU OF LAND MANAGEMENT
ARIZONA STATE OFFICE
ONE NORTH CENTRAL AVE, STE 800
PHOENIX, AZ 85004-4427
OFFICE: (602) 417-9360
FAX: (602) 417-9490; 602-417-9452
paulinebrown@blm.gov
www.blm.gov/az
https://www.facebook.com/BLMArizona

Brown, Pauline <paulinebrown@blm.gov>
To: Sender A <adamsplace773@peoplepc.com>

Tue, Aug 30, 2016 at 3:43 PM

Yes Sir, thank you for responding to my email message, I will attach this message to your packet to be filed.

Take care,

On Tue, Aug 30, 2016 at 3:36 PM, Sender A <adamsplace773@peoplepc.com> wrote:

Dear Pauline Brown,

I'm writing to confirm please DO NOT process the "Notice Of Intent form" that was incorrectly added with Affidavit of assessment work forms.

Thank you for all your assistance, Gary Haley

NOI Form X'd out
8/30/16
PB

—Original Message—

From: "Brown, Pauline"
Sent: Aug 30, 2016 3:27 PM
To: adamsplace773@peoplepc.com
Subject: Fwd: AMC418628, ET AL

Sorry, I forgot the p in the message sent today at 9:39am.
Thank you for returning my call.

Regards,

— Forwarded message —
From: **Brown, Pauline** <paulinebrown@blm.gov>

Date: Tue, Aug 30, 2016 at 9:39 AM
Subject: AMC418628, ET AL
To: adarnsplace773@peoplec.com

To Gary and Connie Haley,

On August 25, 2016, this office received a payment for \$60 (Receipt #3642474); with the payment, you submitted a Notice of interntion (NOI) to hold mining claims form (Form: MCF110) and the Affidavit of annual assessment work (POL) form (Form 3830-4).

For your information, the \$60 payment was applied towards the assessment work on the 6 claims you listed on the POL form. The NOI form is 'optional' at this time because you have been filing a waiver on the same 6 claims since 2015.

If you still want us to process the NOI form, you will need to send in an additional \$60 because the fee to process the NOI is \$10 per mining claim. If you have any questions please feel free to call.

Regards,

—
PAULINE BROWN
LAND LAW EXAMINER
BUREAU OF LAND MANAGEMENT
ARIZONA STATE OFFICE
ONE NORTH CENTRAL AVE, STE 800
PHOENIX, AZ 85004-4427
OFFICE: (602) 417-9360
FAX: (602) 417-9490; 602-417-9452
paulinebrown@blm.gov
www.blm.gov/az
<https://www.facebook.com/BLMArizona>

—
PAULINE BROWN
LAND LAW EXAMINER
BUREAU OF LAND MANAGEMENT
ARIZONA STATE OFFICE
ONE NORTH CENTRAL AVE, STE 800
PHOENIX, AZ 85004-4427
OFFICE: (602) 417-9360
FAX: (602) 417-9490; 602-417-9452
paulinebrown@blm.gov
www.blm.gov/az
<https://www.facebook.com/BLMArizona>

—
PAULINE BROWN
LAND LAW EXAMINER
BUREAU OF LAND MANAGEMENT
ARIZONA STATE OFFICE
ONE NORTH CENTRAL AVE, STE 800
PHOENIX, AZ 85004-4427
OFFICE: (602) 417-9360
FAX: (602) 417-9490; 602-417-9452
paulinebrown@blm.gov
www.blm.gov/az
<https://www.facebook.com/BLMArizona>

MINING CLAIMS
MC Customer Information - With Serial No. and Last Assessment Code
ACTIVE CLAIMS

Page 1 of 1

Admin State: AZ

Geo State: AZ

HALEY GARY
PO BOX 584
GREEN VALLEY, AZ 85622-0584

CUSTOMER ID: 2336330

<u>Serial No.</u>	<u>Claim Name/Number</u>	<u>Last Assmt Code</u>	<u>Last Assmt YR</u>	<u>Disposition</u>
AMC418628	PEACHIE	483	2016	ACTIVE
AMC421116	APACHE MOON	483	2016	ACTIVE
AMC421122	BUZZARDS END	483	2016	ACTIVE
AMC423063	HONEY COMB	483	2016	ACTIVE
AMC423064	APACHE MOON 2	483	2016	ACTIVE
AMC423704	SKID MARK	483	2016	ACTIVE

Number of ACTIVE cases: 6

UNITED STATES
DEPARTMENT OF THE INTERIOR
BUREAU OF LAND MANAGEMENT

421

418628 423063
421116 423064
421122 423704

FORM APPROVED
OMB NO. 1004-0114
Expires: October 31, 2016

MAINTENANCE FEE WAIVER CERTIFICATION

SEE INSTRUCTIONS ON PAGE 2

- This small miner waiver is filed for the assessment year beginning on September 1, 2015 and ending on September 1, 2016.
- The undersigned and all related parties owned ten or fewer mining claims, mill, or tunnel sites located and maintained on Federal lands in the United States of America on September 1, 2016.
- The undersigned have performed the assessment work required by law for each mining claim listed prior to filing this waiver and understand that by filing this form, the undersigned must file an affidavit of assessment work with the Bureau of Land Management (BLM) by the December 30th following the filing of this waiver.
- The undersigned understand that if the assessment work obligation has not yet come due under 30 U.S.C. 28 (for those claims in their first assessment year only), a notice of intent to hold reciting this condition must be recorded by the December 30th following the filing of this waiver.
- The undersigned understand that mill and tunnel sites may also be listed on this waiver and be waived from payment of the maintenance fee, and that a notice of intent to hold for these sites is required to be filed with the BLM by the December 30th following the filing of this waiver.
- The undersigned understand and acknowledge that pursuant to 43 U.S.C. 1212 and 18 U.S.C. 1001, the filing or recording of a false, fictitious, or fraudulent document with the BLM may result in a fine of up to \$250,000, a prison term not to exceed five years, or both.
- The mining claims, mill or tunnel sites for which this waiver from payment of the maintenance fees is requested are:

CLAIM OR SITE NAME	BLM RECORDATION SERIAL NUMBER
1. PEACHIE	418628 ✓
2. BUZZARDS END	421122
3. APACHE MOON	421116
4. APACHE MOON 2	423064
5. HONEYCOMB	423063
6. SKID MARK	423704
7.	
8.	
9.	
10.	

RECEIVED
BLM AZ STATE OFFICE
2015 AUG 25 P 2:18
PHOENIX, ARIZONA

The owner(s) (claimant(s)) of the above mining claims and sites are:

Connie Haley
(Owner's Name - Please Print)
PO Box 584, Green Valley, AZ 85622
(Owner's Mailing Address)

Connie L. Haley
(Owner's Signature)
Green Valley AZ 85622
(City) (State) (Zip Code)

Gary Haley
(Owner's Name - Please Print)
PO Box 584, Green Valley, AZ 85622
(Owner's Mailing Address)

Gary Haley
(Owner's Signature)
Green Valley AZ 85622
(City) (State) (Zip Code)

(Owner's Name - Please Print)
(Owner's Mailing Address)

(Owner's Signature)
(City) (State) (Zip Code)

(Owner's Name - Please Print)
(Owner's Mailing Address)

(Owner's Signature)
(City) (State) (Zip Code)

(Continued on page 2)

Gary Haley
Phone # (520) 648-2040

ENTERED
493
SEP 07 2016
BY: *[Signature]*

NW
[Signature]

Connie Haley

(Owner's Name - Please Print)

X *Connie L. Haley*
(Owner's Signature)

PO Box 584

(Owner's Mailing Address)

Green Valley

(City)

AZ

(State)

85622

(Zip Code)

Gary Haley

(Owner's Name - Please Print)

X *Gary Haley*
(Owner's Signature)

PO Box 584

(Owner's Mailing Address)

Green Valley

(City)

AZ

(State)

85622

(Zip Code)

(Owner's Name - Please Print)

(Owner's Signature)

(Owner's Mailing Address)

(City)

(State)

(Zip Code)

(Owner's Name - Please Print)

(Owner's Signature)

(Owner's Mailing Address)

(City)

(State)

(Zip Code)

18 U.S.C. 1001 and 43 U.S.C. 1212 make it a crime for any person knowingly and willfully to make to any department or agency of the United States any false, fictitious or fraudulent statements or representations as to any matter within its jurisdiction.

INSTRUCTIONS

1. This certification is made under the provisions of 43 U.S.C. § 1744 and 30 U.S.C. §28-28k and the regulations thereunder (43 CFR Part 3830).
2. The claimant(s) must fill in the dates in paragraph 1 for the beginning and ending of the assessment year for which this waiver is sought.
3. The claimant(s) must fill in the date in paragraph 2 for the beginning of the assessment year for which this waiver is sought.
4. All claim and site names and BLM serial numbers must be listed for the mining claims, mill sites, and tunnel sites for which the waiver is sought.
5. All owners of the mining claims, mill sites, and tunnel sites and their addresses must be given.
6. This waiver form must be signed by all the claimants or their designated agent, in original form. If an agent is designated, a notarized designation of agent, signed by all of the claimants with proper address given, must be submitted with this waiver.
7. This form must be filed no later than September 1st for the upcoming assessment year in the BLM State Office where the mining claims or sites are recorded, or the waiver cannot be granted by the BLM. (Example: To obtain a waiver for the assessment year 2012, which begins on September 1, 2011, you must qualify for and file for a waiver no later than September 1, 2011, in the proper BLM State Office.)
8. For all mining claims which require assessment work, you must record an affidavit of labor on or before the December 30th immediately following the filing of this waiver. For all other mining claims or sites waived, you must record a notice of intent to hold on or before the December 30th immediately following the filing of this waiver.
9. Mill and tunnel sites may also be listed on this waiver and be waived from payment of the maintenance fee. A notice of intent to hold for these sites is required to be filed by the December 30th following the filing of this waiver.

RECEIVED
BLM AZ STATE OFFICE
2011 AUG 25 P 2:19
PHOENIX, ARIZONA

FOR OFFICIAL USE ONLY

Gary Haley
Phone # (520) 648-2040

UNITED STATES
DEPARTMENT OF THE INTERIOR
BUREAU OF LAND MANAGEMENT

488

AA

418628 423064
421116 423704
421122
423063
FORM APPROVED
OMB NO. 1004-0114
Expires: October 31, 2016

MAINTENANCE FEE WAIVER CERTIFICATION

SEE INSTRUCTIONS ON PAGE 2

- This small miner waiver is filed for the assessment year beginning on September 1, ~~2014~~²⁰¹⁵ and ending on September 1, ~~2015~~²⁰¹⁶.
- The undersigned and all related parties owned ten or fewer mining claims, mill, or tunnel sites located and maintained on Federal lands in the United States of America on September 1, 2015.
- The undersigned have performed the assessment work required by law for each mining claim listed prior to filing this waiver and understand that by filing this form, the undersigned must file an affidavit of assessment work with the Bureau of Land Management (BLM) by the December 30th following the filing of this waiver.
- The undersigned understand that if the assessment work obligation has not yet come due under 30 U.S.C. 28 (for those claims in their first assessment year only), a notice of intent to hold reciting this condition must be recorded by the December 30th following the filing of this waiver.
- The undersigned understand that mill and tunnel sites may also be listed on this waiver and be waived from payment of the maintenance fee, and that a notice of intent to hold for these sites is required to be filed with the BLM by the December 30th following the filing of this waiver.
- The undersigned understand and acknowledge that pursuant to 43 U.S.C. 1212 and 18 U.S.C. 1091, the filing or recording of a false, fictitious, or fraudulent document with the BLM may result in a fine of up to \$250,000, a prison term not to exceed five years, or both.
- The mining claims, mill or tunnel sites for which this waiver from payment of the maintenance fees is requested are:

CLAIM OR SITE NAME	BLM RECORDATION SERIAL NUMBER
1. Peachie	418628 ✓
2. Buzzards End	421122
3. Apache Moon	421116
4. Apache Moon 2	423064
5. Honeycomb	423063
6. Skid Mark	423704
7.	
8.	
9.	
10.	

RECEIVED
BLM AZ STATE OFFICE
2015 AUG 26 P 3:00
PHOENIX, ARIZONA

The owner(s) (claimants) of the above mining claims and sites are:

Gary Haley
(Owner's Name - Please Print)

PO Box 584, Green Valley, AZ 85622
(Owner's Mailing Address)

Green Valley AZ 85622
(City) (State) (Zip Code)

Gary Haley
(Owner's Signature)

Connie Haley
(Owner's Name - Please Print)

PO Box 584, Green Valley, AZ 85622
(Owner's Mailing Address)

Green Valley AZ 85622
(City) (State) (Zip Code)

Connie Lee Haley
(Owner's Signature)

(Owner's Name - Please Print)

(Owner's Mailing Address)

(City) (State) (Zip Code)

(Owner's Signature)

(Owner's Name - Please Print)

(Owner's Mailing Address)

(City) (State) (Zip Code)

(Owner's Signature)

ENTERED
SEP 1 2015
BY: *[Signature]*

(Continued on page 2)
Gary Haley
Phone # 520-648-2040

NWV
9/9/2015

Gary Haley

(Owner's Name - Please Print)

PO Box 584

(Owner's Mailing Address)

x Gary Haley

(Owner's Signature)

Green Valley

(City)

AZ

(State)

85622

(Zip Code)

Connie Haley

(Owner's Name - Please Print)

PO Box 584

(Owner's Mailing Address)

x Connie Lee Haley

(Owner's Signature)

Green Valley

(City)

AZ

(State)

85622

(Zip Code)

(Owner's Name - Please Print)

(Owner's Signature)

(Owner's Mailing Address)

(City)

(State)

(Zip Code)

(Owner's Name - Please Print)

(Owner's Signature)

(Owner's Mailing Address)

(City)

(State)

(Zip Code)

PHOENIX, ARIZONA
2015 AUG 26 P 3:00
BLM STATE OFFICE

18 U.S.C. 1001 and 43 U.S.C. 1212 make it a crime for any person knowingly and willfully to make to any department or agency of the United States any false, fictitious or fraudulent statements or representations as to any matter within its jurisdiction.

INSTRUCTIONS

1. This certification is made under the provisions of 43 U.S.C. § 1744 and 30 U.S.C. §28-28k and the regulations thereunder (43 CFR Part 3830).
2. The claimant(s) must fill in the dates in paragraph 1 for the beginning and ending of the assessment year for which this waiver is sought.
3. The claimant(s) must fill in the date in paragraph 2 for the beginning of the assessment year for which this waiver is sought.
4. All claim and site names and BLM serial numbers must be listed for the mining claims, mill sites, and tunnel sites for which the waiver is sought.
5. All owners of the mining claims, mill sites, and tunnel sites and their addresses must be given.
6. This waiver form must be signed by all the claimants or their designated agent, in original form. If an agent is designated, a notarized designation of agent, signed by all of the claimants with proper address given, must be submitted with this waiver.
7. This form must be filed no later than September 1st for the upcoming assessment year in the BLM State Office where the mining claims or sites are recorded, or the waiver cannot be granted by the BLM. (Example: To obtain a waiver for the assessment year 2012, which begins on September 1, 2011, you must qualify for and file for a waiver no later than September 1, 2011, in the proper BLM State Office.)
8. For all mining claims which require assessment work, you must record an affidavit of labor on or before the December 30th immediately following the filing of this waiver. For all other mining claims or sites waived, you must record a notice of intent to hold on or before the December 30th immediately following the filing of this waiver.
9. Mill and tunnel sites may also be listed on this waiver and be waived from payment of the maintenance fee. A notice of intent to hold for these sites is required to be filed by the December 30th following the filing of this waiver.

FOR OFFICIAL USE ONLY

When Recorded Return Document to:

418628
421116
421122
423063
423064
423704

Check here is this is a change of address.

Telephone: _____

E-mail address: _____

AFFIDAVIT OF PERFORMANCE OF ANNUAL WORK

1. State of Arizona, County of Pima ss:

2. I (Name) Connie Haley + Gary Haley

3. Reside at (Address) PO Box 584

RECEIVED
BLM
2015 AUG 26 P 3:00
PHOENIX, ARIZONA

City Green Valley County Pima

State AZ zip 85622 being duly sworn, depose and say that I am a citizen of the United States, more than eighteen years of age, and that all of the facts set forth in this affidavit, subject to the provisions and penalties of 18 U.S.C. 1001 pertaining to the filing of false, fictitious, or fraudulent statements with the United States, are true and correct according to the best of my knowledge, information and belief.

4. Owner's name and address (If not shown in Items 1-3 above).
Connie Haley, Gary Haley, PO BOX 584, Green Valley, AZ 85622

5. That I am personally acquainted with the mining claim(s). The work and improvements were made by and at the expense of the owner(s) of said claim(s). Said contiguous group of claims, listed on this document, are situated in the

Gilla & Salt River (optional) Mining District; Pima County, Arizona.

Line No.	AMC NUMBER	CLAIM/SITE NAME	COUNTY RECORDER DATA (If available)	TWP	RNG	SEC
1	418628	Peachie	20123130204	17S	12E	003
2	421122	Buzzards End	20130590127	17S	10E	026
3	421116	Apache Moon	20130590128	17S	10E	026
4	423064	Apache Moon 2	20131420840	17S	10E	026
5	423063	Honeycomb	20131420839	17S	10E	026
6	423704	Skid Mark	20132050174	17S	10E	026

Form: MCF108
Revised July 2014
Page 1 of 2

ENTERED
AUG 31 2015
BY: ek

Gary Haley
Phone # 520-648-2040

BLM
Date
Stamp

2015 AUG 26 P 3 01
PHOENIX, ARIZONA

RECEIVED
PIMA COUNTY OFFICE

7					
8					
9					
10					

6. That between the dates starting at 12 o'clock noon on September 1, 20 14 and ending at 12 o'clock noon on September 1, 20 15 at least \$ 1,100. dollars worth of work and improvements were done and performed upon said claim(s) or upon one or more of a contiguous group of claims for the benefit of all, wholly or partly outside of a contiguous group of claims for the benefit of all, not including the location work.

7. That the following persons were employed to perform the work and improvements described herein: _____

Gary Haley, Connie Haley

8. That the work and improvements performed were: Repaired roads, cut brush, leveled dips, Fixed claim markers, filled in washed out spots.

9. Dated: 8-18-15 Signature: Gary Haley, Connie Haley

SUBSCRIBED AND SWORN TO before me, a Notary Public, this 18 day of August 20 15

By: Gary Haley & Connie Haley

Notary Public [Signature]

My Commission Expires 05/18/18 05/04/18

Bureau of Land Management
Arizona State Office
www.blm.gov/az

No. of Claims: 6 x \$10 = \$60.00
Check No.: 0965 Init. [Initials]
Receipt No.: 3378653
For BLM Use Only

 Natalie Mazon
Notary Public
Pima County, Arizona
My Comm. Expires 05-04-18

Form: MCF108
Revised July 2014
Page 2 of 2

NOTICE OF INTENTION TO HOLD MINING CLAIMS/SITES

When Recorded Return Document to:

Check here if this is a change of address.

Telephone: _____

E-mail Address: _____

RECEIVED

2015 AUG 26 P 3:00

PHOENIX, ARIZONA

BLM
Date
Stamp

I (We) intend to hold the claims(s) and/or site(s) listed below for the calendar year 2015, and I (We) have filed or will file a Notice of Intent to Hold in the county where the claim (s) is located.

Reason for filing a Notice of Intent to Hold instead of an assessment work filing (check one):

- Maintenance fee was paid to maintain claim(s) during this assessment year.
- Mill or tunnel sites.
- Claim(s) was located during the current assessment year.
- BLM has deferred assessment work (attach copy of decision granting deferment, or pending petition for deferment including date petition was filed.)

Line No.	AMC NUMBER	CLAIM/SITE NAME	COUNTY RECORDER DATA (If available)	TWP	RNG	SEC
1	418628	Peachie	20123130204	17S	12E	003
2	421122	Buzzards End	20130590127	17S	10E	026
3	421116	Apache Moon	20130590128	17S	10E	026
4	423064	Apache Moon 2	20131420840	17S	10E	026
5	423063	Honeycomb	20131420839	17S	10E	026
6	423704	Skid Mark	20132050174	17S	10E	026
7						
8						
9						
10						

Gary Haley
 Phone # 520-648-2040

NOTICE OF INTENTION TO HOLD MINING CLAIMS/SITES
page 2

BLM
Date
Stamp

2015 AUG 26 P 3:00
PHOENIX, ARIZONA

BLM RECEIVED
OFFICE

1. State of Arizona, County of Pima

2. I (Name) Connie Haley, Gary Haley

3. Reside at (Address) 16621 Horse Hollow Trail

City Sahuarita County Pima State AZ Zip 85629 being duly sworn, depose and say that I am a citizen of the United States, more than eighteen years of age, that all of the facts set forth in this notice, subject to the provisions and penalties of 18 U.S.C. 1001 pertaining to the filing of false, fictitious, or fraudulent statements with the United States, are true and correct according to the best of my knowledge, information and belief.

4. Owner's name and address (If not shown in Items 1-3 above). Connie Haley, Gary Haley

5. Dated: _____ Signature: Connie L. Haley, Gary Haley

Bureau of Land Management
Arizona State Office
www.blm.gov/az

No. of Claims: _____ x \$10 = _____
Check No: _____ Init. _____
Receipt No.: _____
For BLM Use Only

Connie & Gary Haley
PO Box 584
Green Valley, AZ 85622



7015 0640 0006 5034 0665



1000



85004

U.S. POSTAGE
PAID
GREEN VALLEY, AZ
85614
AUG 20, 16
AMOUNT
\$4.65
R2304M112169-1

RECEIVED
BUREAU OF LAND MANAGEMENT
2015 AUG 26 P 3:00
PHOENIX, ARIZONA

**UNITED STATES
DEPARTMENT OF INTERIOR**
Bureau of Land Management
Arizona State Office
One North Central Avenue, Suite 800
Phoenix, Arizona 85004-4427

United States Department of the Interior
Bureau of Land Management
 LANDS/RECREATION & PLANNING
 ONE N CENTRAL AVE
 PHOENIX, AZ 85004 -2203
 Phone: 602-417-9200

Receipt

No: 3378653

Transaction #: 3476906	
Date of Transaction: 08/27/2015	
CUSTOMER:	
GARY L HALEY PO BOX 584 GREEN VALLEY, AZ 85622-0584 US	

LINE #	QTY	DESCRIPTION	REMARKS	UNIT PRICE	TOTAL
1	1.00	LOCATABLE MINERALS / MINING CLAIMS-NOT NEW-UNADJUD, ONE AUTH NO. ONLY / MINING CLAIM MONEY RECEIVED CASES: AMC418628/\$60.00	WAIVER - 6 2016 / POL - 6 2015 / NOI - 6 2015	- n/a -	60.00
TOTAL:					\$60.00

PAYMENT INFORMATION			
1	AMOUNT:	60.00	POSTMARKED: 08/20/2015
	TYPE:	CHECK	RECEIVED: 08/26/2015
	CHECK NO:	0965	
	NAME:	HALEY, GARY L PO BOX 584 GREEN VALLEY AZ 85622-0584 US	

REMARKS

This receipt was generated by the automated BLM Collections and Billing System and is a paper representation of a portion of the official electronic record contained therein.

ENTERED
 AUG 31 2015
 BY: *jr*

8/27/2015

UNITED STATES
DEPARTMENT OF THE INTERIOR
BUREAU OF LAND MANAGEMENT

1578

MAINTENANCE FEE WAIVER CERTIFICATION

[Handwritten Signature]

AMC 418628
421122
421116
423064
FORM APPROVED 423063
OMB NO. 1004-0114 423704
Expires: October 31, 2016

SEE INSTRUCTIONS ON PAGE 2

- This small miner waiver is filed for the assessment year beginning on September 1, ~~2013~~²⁰¹⁴ and ending on September 1, ~~2014~~²⁰¹⁵.
- The undersigned and all related parties owned ten or fewer mining claims, mill, or tunnel sites located and maintained on Federal lands in the United States of America on September 1, 2014.
- The undersigned have performed the assessment work required by law for each mining claim listed prior to filing this waiver and understand that by filing this form, the undersigned must file an affidavit of assessment work with the Bureau of Land Management (BLM) by the December 30th following the filing of this waiver.
- The undersigned understand that if the assessment work obligation has not yet come due under 30 U.S.C. 28 (for those claims in their first assessment year only), a notice of intent to hold reciting this condition must be recorded by the December 30th following the filing of this waiver.
- The undersigned understand that mill and tunnel sites may also be listed on this waiver and be waived from payment of the maintenance fee, and that a notice of intent to hold for these sites is required to be filed with the BLM by the December 30th following the filing of this waiver.
- The undersigned understand and acknowledge that pursuant to 43 U.S.C. 1212 and 18 U.S.C. 1001, the filing or recording of a false, fictitious, or fraudulent document with the BLM may result in a fine of up to \$250,000, a prison term not to exceed five years, or both.
- The mining claims, mill or tunnel sites for which this waiver from payment of the maintenance fees is requested are:

CLAIM OR SITE NAME	BLM RECORDATION SERIAL NUMBER
1. Peachie	✓ 418628
2. Buzzards End	421122
3. Apache Moon	421116
4. Apache Moon 2	423064
5. Honeycomb	423063
6. Skid Mark	423704
7.	
8.	
9.	
10.	

RECEIVED
 BLM AZ STATE OFFICE
 PHOENIX, ARIZONA
 2014 AUG 27 P 2:21

The owner(s) (claimants) of the above mining claims and sites are:

Gary Haley
 (Owner's Name - Please Print)
 PO Box 584, Green Valley, AZ 85622
 (Owner's Mailing Address)

x Gary Haley
 (Owner's Signature)
 Green Valley (City) AZ (State) 85622 (Zip Code)

Connie Haley
 (Owner's Name - Please Print)
 PO Box 584, Green Valley, AZ 85622
 (Owner's Mailing Address)

x Connie L. Haley
 (Owner's Signature)
 Green Valley (City) AZ (State) 85622 (Zip Code)

 (Owner's Name - Please Print)

 (Owner's Mailing Address)

 (Owner's Signature)
 _____ (City) _____ (State) _____ (Zip Code)

 (Owner's Name - Please Print)

 (Owner's Mailing Address)

 (Owner's Signature)
 _____ (City) _____ (State) _____ (Zip Code)

(Continued on page 2)

INTERESTED
 SEP 15 2014
 BY: *DM*

NWJ
 9/23/2014
pm

(Owner's Name - Please Print)	(Owner's Signature)
(Owner's Mailing Address)	(City) (State) (Zip Code)
(Owner's Name - Please Print)	(Owner's Signature)
(Owner's Mailing Address)	(City) (State) (Zip Code)
(Owner's Name - Please Print)	(Owner's Signature)
(Owner's Mailing Address)	(City) (State) (Zip Code)
(Owner's Name - Please Print)	(Owner's Signature)
(Owner's Mailing Address)	(City) (State) (Zip Code)

18 U.S.C. 1001 and 43 U.S.C. 1212 make it a crime for any person knowingly and willfully to make to any department or agency of the United States any false, fictitious or fraudulent statements or representations as to any matter within its jurisdiction.

INSTRUCTIONS

1. This certification is made under the provisions of 43 U.S.C. § 1744 and 30 U.S.C. §28-28k and the regulations thereunder (43 CFR Part 3830).
2. The claimant(s) must fill in the dates in paragraph 1 for the beginning and ending of the assessment year for which this waiver is sought.
3. The claimant(s) must fill in the date in paragraph 2 for the beginning of the assessment year for which this waiver is sought.
4. All claim and site names and BLM serial numbers must be listed for the mining claims, mill sites, and tunnel sites for which the waiver is sought.
5. All owners of the mining claims, mill sites, and tunnel sites and their addresses must be given.
6. This waiver form must be signed by all the claimants or their designated agent, in original form. If an agent is designated, a notarized designation of agent, signed by all of the claimants with proper address given, must be submitted with this waiver.
7. This form must be filed no later than September 1st for the upcoming assessment year in the BLM State Office where the mining claims or sites are recorded, or the waiver cannot be granted by the BLM. (Example: To obtain a waiver for the assessment year 2012, which begins on September 1, 2011, you must qualify for and file for a waiver no later than September 1, 2011, in the proper BLM State Office.)
8. For all mining claims which require assessment work, you must record an affidavit of labor on or before the December 30th immediately following the filing of this waiver. For all other mining claims or sites waived, you must record a notice of intent to hold on or before the December 30th immediately following the filing of this waiver.
9. Mill and tunnel sites may also be listed on this waiver and be waived from payment of the maintenance fee. A notice of intent to hold for these sites is required to be filed by the December 30th following the filing of this waiver.

RECEIVED
 BLM AZ STATE OFFICE
 PHOENIX, ARIZONA
 2011 AUG 27 P 2:21

FOR OFFICIAL USE ONLY

NOTICE OF INTENTION TO HOLD MINING CLAIMS/SITES
page 2

BLM
Date
Stamp

PHOENIX, ARIZONA

2011 AUG 21 P 2:21

RECEIVED
BLM AZ STATE OFFICE

1. State of Arizona, County of Pima

2. I (Name) Connie Haley & Gary Haley

3. Reside at (Address) 16621 Horse Hollow Trail

City Sahuarita County Pima State AZ Zip 85629 being duly sworn, depose and say that I am a citizen of the United States, more than eighteen years of age, that all of the facts set forth in this notice, subject to the provisions and penalties of 18 U.S.C. 1001 pertaining to the filing of false, fictitious, or fraudulent statements with the United States, are true and correct according to the best of my knowledge, information and belief.

4. Owner's name and address (If not shown in Items 1-3 above). _____

5. Dated: Aug 26 2011 Signature: Gary Haley Connie Lee Haley

Bureau of Land Management
Arizona State Office
www.az.blm.gov

No. of Claims: 6 x \$10 = \$60
Check No: 801 Init. CH
Receipt No.: 3115369
For BLM Use Only

418628

Form 3830-4
(October 2013)

UNITED STATES
DEPARTMENT OF THE INTERIOR
BUREAU OF LAND MANAGEMENT

FORM APPROVED 421122
OMB NO.: 1004-0114
Expires: October 31, 2016 421116
423063
423064

AFFIDAVIT OF ANNUAL ASSESSMENT WORK

423704

WHEN RECORDED, MAIL DOCUMENT TO:

NAME: Gary & Connie Haley

ADDRESS: PO Box 584

CITY, STATE, ZIP: Green Valley, AZ 85622

FOR COUNTY RECORDER'S USE

No. of Claims 6
x \$10/claim
Total due BLM \$ 60.

TO ALL WHOM IT MAY CONCERN:

1. The undersigned certifies that at least \$100 per claim was expended for development, labor and improvements, or equivalent value added, as the annual assessment work for the assessment year ending September 1, 2014 for the following contiguous unpatented mining claim(s), located in the County of Pima, in the State of Arizona.

BLM Serial No.	Name of Claim	Tp	Rg	Sec	Mer	County Recordation Book and Page No.	Date
418628	Peachie	17 S	12 E	003	Gila & S	20123130204 page 3	11/08/2012
421122	Buzzards End	17 S	10 E	026	Gila & S	20130590127 page 2	2/28/2013
421116	Apache Moon	17 S	10 E	026	Gila & S	20130590128 page 2	2/28/2013
423064	Apache Moon 2	17 S	10 E	026	Gila & S	20131420840 page 3	5/22/2013
423063	Honeycomb	17 S	10 E	026	Gila & S	20131420839 page 3	5/22/2013
423704	Skid Mark	17 S	10 E	026	Gila & S	20132050174 page 2	7/24/2013

RECEIVED
BLM AT STATE OFFICE
2014 AUG 21 P 2:21
PHOENIX, ARIZONA

(Continued on page 2)

AUG 18 2014
RAN

RECEIPT # 3115369

2. Type of labor and improvements (specify what was done and give the total value for that labor and improvement to show at least \$100 for each claim). If a geological, geochemical, or geophysical survey was performed, as per 30 U.S.C. 28-1, reference the title of the report of survey, give cost and date of the survey and report, and indicate it was filed with the County Recorder:

Description of Work Performed	Value of Work Performed	Date Work Was Performed
Roadwork (potholes filled), trash cleanup.	\$200.	October 7, 2013
Leveled road, jackhammer work, brush/ rock removal, etc.	\$600.	January 4, 2014
Fixed washed out road, remove roadblock & cut brush.	\$250.	March 16, 2014
Removed brush from blocking the roads.	\$100.	April 8, 2014
Backfilled holes on claim roads.	\$250.	May 5, 2014

3. Name and mailing address of each person who performed the labor and improvements:

Name (please print)

Gary Haley

 Connie Haley

Current Mailing Address (please print)

PO Box 584, Green Valley, AZ 85622

 PO Box 584, Green Valley, AZ 85622

4. Name and mailing address of each person who holds and claims the subject mining claim(s) for the valuable minerals contained therein. Be sure to indicate if there is a change of address:

Name (please print)

Gary Haley

 Connie L Haley

Current Mailing Address (please print)

PO Box 584, Green Valley, AZ 85622

 PO Box 584, Green Valley, AZ 85622

RECEIVED
 BLM AZ STATE OFFICE
 2014 AUG 27 10 21
 PHOENIX, ARIZONA

5. The undersigned testifies that on the date of August 26, 2014, all monuments required by law were erected upon the subject claim(s), and all notices required by law were posted on the subject claim(s) or copies thereof were in place, and at said date, each corner monument bore or contained

markings sufficient to appropriately designate the corner of the claim to which it pertains and the name of the claim(s).

I hereby certify under penalty of perjury under the laws of the State of Arizona that the foregoing statements are true and correct:

Gary Haley Date: 8-25-2014
(Signature of person responsible for above statement)

Title 18 U.S.C. 1001 and 43 U.S.C. 1212 make it a crime for any person knowingly and willfully to make to any department or agency of the United States any false, fictitious or fraudulent statements or representations as to any matter within its jurisdiction.

Notary Block

SUBSCRIBED AND SWORN TO before me, this 25 day of August 2014

By: Victoria Ochoa
(Signature of Arriant)

Title: Notary Public

My Commission Expires: 9/30/2014

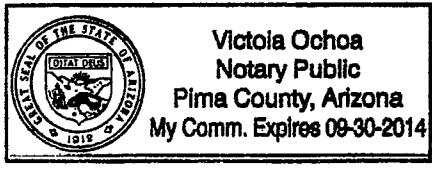

INSTRUCTIONS

1. This is an optional form that may be used to satisfy the requirements for the Bureau of Land Management (BLM) under the provisions of 43 U.S.C. §1744 and 30 U.S.C. §28-28d and the regulations thereunder (43 CFR part 3835). Since local and State laws may vary, you should contact your local and State agencies where the claims are located to ensure all applicable laws and requirements are satisfied.
2. The claimant(s) must fill in the date in paragraph 1 for the applicable assessment year and the county and state where the claims are located.
3. All claim names, BLM serial numbers, legal descriptions, and original county recording information must be listed for the claims pertaining to this assessment notice.
4. The claimant(s) must complete paragraph 2 listing all labor or improvements which was performed on or did benefit the subject mining claims. The value and date of the labor or improvements must also be listed. The total amount of labor or improvements can be listed, but the total expenditure must equal at least \$100 for each claim.
5. The names and current mailing addresses of the person(s) performing the labor shall be listed in paragraph 3.
6. The name and current mailing address of each owner (claimant) of the claims shall be listed in paragraph 4. The mailing address shall be the owner's address and not the address of an agent or anyone representing the claimant. Be sure to note if there has been a change of address.
7. Paragraph 5 shall be completed to show the date it was verified that all monuments required by law were properly erected, all notices were posted, and that corners were appropriately designated for all claims listed.
8. An exact legible reproduction or duplicate (other than microfilm or other electronic media) of this affidavit or another type of affidavit of assessment work that you file or will file in the county where each claim is located must be filed with the BLM on or before December 30 of the calendar year in which the assessment year ends. For mill or tunnel sites, a separate notice of intent to hold must be filed with the BLM on or before December 30. Requirements for filing a notice of intent to hold can be found at 43 CFR 3835.33.
9. A processing fee of \$10 for each claim listed must be remitted to the BLM along with this or any other affidavit of assessment work.

RECEIVED
BLM
AUG 27 P 2:21
PIMA COUNTY ARIZONA

Connie & Gary Haley
PO Box 584
Green Valley, AZ 85622



7012 2920 0000 3116 0080

U.S. POSTAGE
PAID
GREEN VALLEY, AZ
AUG 25 '14
AMOUNT
\$4.49
00075310-05



1000 85004

BLM
one North Central Ave. Suite 800
Phoenix AZ 85004-4427

RECEIVED
DIM AZ STATE OFFICE
2014 AUG 27 P 2 21
PHOENIX, ARIZONA

NOTICE OF INTENTION TO HOLD MINING CLAIMS/SITES

When Recorded Return Document to:

Gary & Connie Haley
P.O. Box 584
Green Valley, AZ 85622

RECEIVED
 BLM ARLINGTON REGION
 2014 NOV 17 P 3:13
 PHOENIX, ARIZONA
 BLM
 Date
 Stamp

Check here if this is a change of address.

Telephone: 520 648-2040

E-mail Address adamsplace773@peoplepc.com

I (We) intend to hold the claims(s) and/or site(s) listed below for the calendar year 2014, and I (We) have filed or will file a Notice of Intent to Hold in the county where the claim (s) is located.

Reason for filing a Notice of Intent to Hold instead of an assessment work filing (check one):

- Maintenance fee was paid to maintain claim(s) during this assessment year.
- Mill or tunnel sites.
- Claim(s) was located during the current assessment year.
- BLM has deferred assessment work (attach copy of decision granting deferment, or pending petition for deferment including date petition was filed.)

Line No.	AMC NUMBER	CLAIM/SITE NAME	COUNTY RECORDER DATA (if available)	TWP	RNG	SEC
1	418628	Peachie	201231302041793	17S	12E	003
2	421122	Buzzards End	20130590127 pg2	17S	10E	026
3	421116	Apache Moon	20130590128 pg2	17S	10E	026
4	423064	Apache Moon 2	20131420840 pg3	17S	10E	026
5	423063	Honeycomb	20131420839 pg3	17S	10E	026
6	423704	Skid Mark	20132050174 pg2	17S	10E	026
7						
8						
9						
10						

Form: MCF110
 Revised Jan.2006
 Page 1 of 2

ENTERED
 DEC 03 2014
 BY: RM

SENT BOTH NOI &
 POL. NOI REQUIRED.

NOTICE OF INTENTION TO HOLD MINING CLAIMS/SITES
page 2

RECEIVED
BLM AZ STATE OFFICE
2014 NOV 17 P 3: 13
PHOENIX, ARIZONA
BLM
Date
Stamp

1. State of Arizona, County of Pima

2. I (Name) Gary + Connie Haley

3. Reside at (Address) PO Box 584

City Green Valley County Pima State AZ Zip 85622 being duly sworn, depose and say that I am a citizen of the United States, more than eighteen years of age, that all of the facts set forth in this notice, subject to the provisions and penalties of 18 U.S.C. 1001 pertaining to the filing of false, fictitious, or fraudulent statements with the United States, are true and correct according to the best of my knowledge, information and belief.

4. Owner's name and address (If not shown in Items 1-3 above). _____

5. Dated: 11-10-14 Signature: Gary Haley - Connie Lee Haley

Bureau of Land Management
Arizona State Office
www.az.blm.gov

No. of Claims: _____ x \$10 = _____
Check No: _____ Init. _____
Receipt No.: 3115369
For BLM Use Only

paid

Connie & Gary Haley
PO Box 584
Green Valley, AZ 85622

PHOENIX AZ 852

15 NOV 2014 PM 5 L



RECEIVED
RUM AZ STATE OFFICE

2014 NOV 17 P 3:06 **3LM**

PHOENIX, ARIZONA *Arizona State office*
One North Central Ave. suite 800
Phoenix, AZ 85004-4427
ATTN: Re'Ann Myers

85004442700

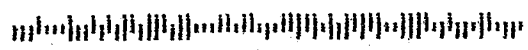

United States Department of the Interior
Bureau of Land Management
 LANDS/RECREATION & PLANNING
 ONE N CENTRAL AVE
 PHOENIX, AZ 85004 -2203
 Phone: 602-417-9200

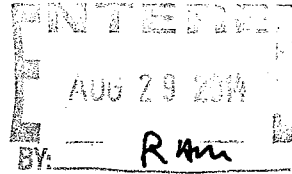

Receipt

No:

3115369

Transaction #: 3207111

Date of Transaction: 08/28/2014

CUSTOMER:

GARY L HALEY
 PO BOX 584
 GREEN VALLEY, AZ 85622-0584 US

LINE #	QTY	DESCRIPTION	REMARKS	UNIT PRICE	TOTAL
1	1.00	LOCATABLE MINERALS / MINING CLAIMS-NOT NEW-UNADJUD, ONE AUTH NO. ONLY / MINING CLAIM MONEY RECEIVED CASES: AMC418628/\$60.00	MAINT FEE WAIVER (6) 2015 / POL (6) 2014 / NOI (2ND PAGE ONLY)	- n/a -	60.00
TOTAL:					\$60.00

PAYMENT INFORMATION

1	AMOUNT:	60.00	POSTMARKED:	08/25/2014
	TYPE:	CHECK	RECEIVED:	08/27/2014
	CHECK NO:	801		
	NAME:	HALEY, GARY L PO BOX 584 GREEN VALLEY AZ 85622-0584 US		

REMARKS

This receipt was generated by the automated BLM Collections and Billing System and is a paper representation of a portion of the official electronic record contained therein.

UNITED STATES
DEPARTMENT OF THE INTERIOR
BUREAU OF LAND MANAGEMENT
MAINTENANCE FEE PAYMENT FORM FOR
LODE CLAIMS, MILL SITES, AND TUNNEL SITES

AMC 418628
AMC 421122
AMC 421116
AMC 423064
AMC 423063
AMC 423704

Remitter Name: Connie L. Haloy - Mary Haloy
Mailing Address: PO Box 584
City, State, Zip: Green Valley, AZ 85622

Check here if this is a change of address.

FOR COUNTY RECORDER'S USE

No. of claims/sites 6
x \$140 per claim/site
Total due BLM \$ 840.00

1. The maintenance fee may be paid by cash, check, money order, Bureau of Land Management (BLM) Declining Deposit Account, or credit card (VISA, American Express, Discover, or MasterCard). Payments must be remitted to the BLM State Office where your claim or site is recorded and received on or before September 1. If the payment is mailed, the envelope must be postmarked by a bona fide delivery service on or before September 1 and received at the proper BLM State Office within 15 calendar days after the due date. Payments may also be made by telephone using a credit card. A complete listing of BLM State Offices with their addresses and phone numbers can be found at <http://www.blm.gov>.

2. The maintenance fee for the following claim(s)/site(s) applies to the assessment year 2014.

CLAIM/SITE NAME	BLM SERIAL NO.
<u>Peachie</u>	<u>AMC 418628</u>
<u>Buzzards End</u>	<u>AMC 421122</u>
<u>Apache Moon</u>	<u>AMC 421116</u>
<u>* Apache Moon 2</u>	<u>AMC 423064</u>
<u>Honeycomb</u>	<u>AMC 423063</u>
<u>Skid Mark</u>	<u>AMC 423704</u>

Use a separate sheet for additional claim/site names, serial numbers, and claimant names and addresses.

(Continued on page 2)

Receipt # 2865545
A.H.

ENTERED
SEP 03 2013
BY: TS

RECEIVED
BLM AZ STATE OFFICE
PHOENIX, ARIZONA
2013 AUG 26 P 12:57

United States Department of the Interior
Bureau of Land Management
 LANDS/RECREATION & PLANNING
 ONE N CENTRAL AVE
 PHOENIX, AZ 85004 -2203
 Phone: 602-417-9200

Receipt

No: 2865545

Transaction #: 2951466	
Date of Transaction: 08/27/2013	
CUSTOMER:	
CONNIE HALEY PO BOX 584 GREEN VALLEY, AZ 85622 US	

LINE #	QTY	DESCRIPTION	REMARKS	UNIT PRICE	TOTAL
1	1.00	LOCATABLE MINERALS / MINING CLAIMS- NOT NEW-UNADJUD, ONE AUTH NO. ONLY / MINING CLAIM MONEY RECEIVED CASES: AMC418628/\$840.00	MAINT FEE PYMNT (6) 2014	- n/a -	840.00
TOTAL:					\$840.00

PAYMENT INFORMATION					
1	AMOUNT:	840.00	POSTMARKED:	08/24/2013	
	TYPE:	CHECK	RECEIVED:	08/26/2013	
	CHECK NO:	644			
	NAME:	HALEY, GARY L PO BOX 584 GREEN VALLEY AZ 85622 US			

REMARKS

This receipt was generated by the automated BLM Collections and Billing System and is a paper representation of a portion of the official electronic record contained therein.

NOTICE!!

These documents have been scanned!

Do not place un-scanned documents beneath this notice!

Do not remove this notice from this file!

GPO Jacket No. 560-102
Print Order 61540
Rise Business Services, LLC
Job=AZ15 5/13/2019



Box Number= AZ15039



Claim Begin-End: AMC423704-AMC423704

6 Location Notices-Amendments and Supporting Documents



AZ15039-14

AMC423162-AMC423771

DEPARTMENT OF THE INTERIOR
BUREAU OF LAND MANAGEMENT
MINING CLAIMS
(LIVE) Serial Register Page

Run Date/Time: 07/10/2013 01:49 PM

01 05-10-1872;017STAT0091;30USC26,28,34 Case Type 384101: LODE CLAIM Claim Name: SKID MARK Commodity : Case Disposition: ACTIVE Required Maintenance Fee: \$140.00	Total Acres 20.660	Serial Number AMC423704 Lead File Number AMC423704
---	-------------------------------------	---

Name & Address	Int Rel
HALEY CONNIE PO BOX 584 GREEN VALLEY, AZ 85622-0584	CLAIMANT
HALEY GARY PO BOX 584 GREEN VALLEY, AZ 85622-0584	CLAIMANT

Mer Twp Rng Sec Quadrant	District/Field Office	County
14 0170S 0100E 026 NE,SE	TUCSON FO	PIMA

Act Date	Code	Action	Action Remarks	Receipt Number
04/15/2013	403	LOCATION DATE		
06/27/2013	395	RECORDATION NOTICE RECD	1	2822024
06/27/2013	484	LOCATION YEAR / MAINTENANCE	2013;\$140	2822024
06/27/2013	501	ACCT ADV IN LEAD FILE	AMC423704;	

Line Nr Remarks

MINI CLAIM STATUS REPORT

DATA ENTERED JUL 10 2013 PB

MTP Checked by JUL 10 2013 PB

GEO Checked by JUL 10 2013 PB

LEAD SERIAL NUMBER AMC 423704 thru AMC

OF CLAIMS & TYPE

1 LODE
PLACER
ASSOCIATION PLACER
MILL SITE
TUNNEL SITE

CHARGES

Location Fee @ \$34 = \$ 34.00
Processing Fee @ \$15 = \$ 15.00
Maintenance Fee @ \$140 = \$ 140.00
Overage (+) \$
Shortage (-) \$
Other Fees \$

TOTAL \$ 189.00

TOTAL CLAIM ACREAGE?

OF LOCATORS?

DOCUMENTS RECEIVED VIA -

Over-the-Counter [] Mail []

TIMELY FILED?

Yes [] No []

LEGAL DESCRIPTION - T 175 R 105 SEC 26
T R SEC
T R SEC
T R SEC

BLM [] FOREST SERVICE [] SUBJ TO PL 359: Yes [] No []

WILDERNESS AREA: No [] Yes []

SPLIT ESTATE - N/A [] SX [] PX [] SRHA [] OTHER []

Proper Notice Filed if Located on SHRA Lands? N/A [] Yes [] No []

RECONVEYED MINERALS ON BLM LANDS REQUIRE OPENING ORDERS FROM 1944 TO 1993 -

Open to Entry on: N/A []

COMMENTS/STATUS - VOID [] PARTIALLY VOID [] PVT MINERALS [] WITHDRAWN LANDS []

OTHER []

Claimant acknowledges that portions of the following claims(s) site(s) may be void or voidable.

Printed Name of Claimant Signature of Claimant

***** FINAL ADJUDICATION *****

DATE 8/16/13 INITIALS AT

AMC423704

LOCATION NOTICE FOR LODE MINING CLAIM

NOTICE IS HEREBY GIVEN that the Skid Mark
lode mining claim has been located
by Connie Haley + Gary Haley whose current mailing
address is PO Box 584 Green Valley,
Arizona, 85622

RECEIVED
M & M OFFICE
PHOENIX, ARIZONA
MAY 27 11:12:42
BLM
Date
Stamp

The general course of this claim is N.W. to S.E. and it is situated in Pima
County, Arizona. This claim is 1500 feet in length and 600 feet in width. This claim runs
from the location monument on which this location notice is posted approximately 1500 feet in a
South direction to the South end line and 0 feet in a North direction to the
North end line. This claim is marked by six monuments, one at each corner and one at the center of each
end line of the claim.

The location monument on which this notice is posted is situated within Section 026, Township 17
S, Range 10 E, Gila Salt River Base and Meridian, Arizona and this claim encompasses portions
of the following quarter section (s), section (s), Township (s) and Range (s) NE + SE 1/4 of Section
026, Township 17 South, Range 12 East.

Gila Salt River Base and Meridian, Arizona.

The locality of this claim with reference to some natural object or permanent monument and additional information
(if any) concerning its locality are as follows: Location Marker is 1.0 miles NE of Providencia
Hill and 1.7 miles SW of Valencia Mountain, Longitude + Latitude of Location
Marker (C+R line A-B)(A) N.31°55.426' + W.111°17.298 (+/B) N.31°55.204' + W.111°17.174'

DATED AND POSTED on the ground this 15 day of April, 2013.

LOCATOR (s) Connie L. Haley - Gary Haley

Form MCF100
Revised July 2005

110123704

RECEIVED
 BLM AZ STATE OFFICE
 2013 JUN 27 PM 12:22
 PHOENIX, ARIZONA
 Lode Placer

MINING CLAIM MAP

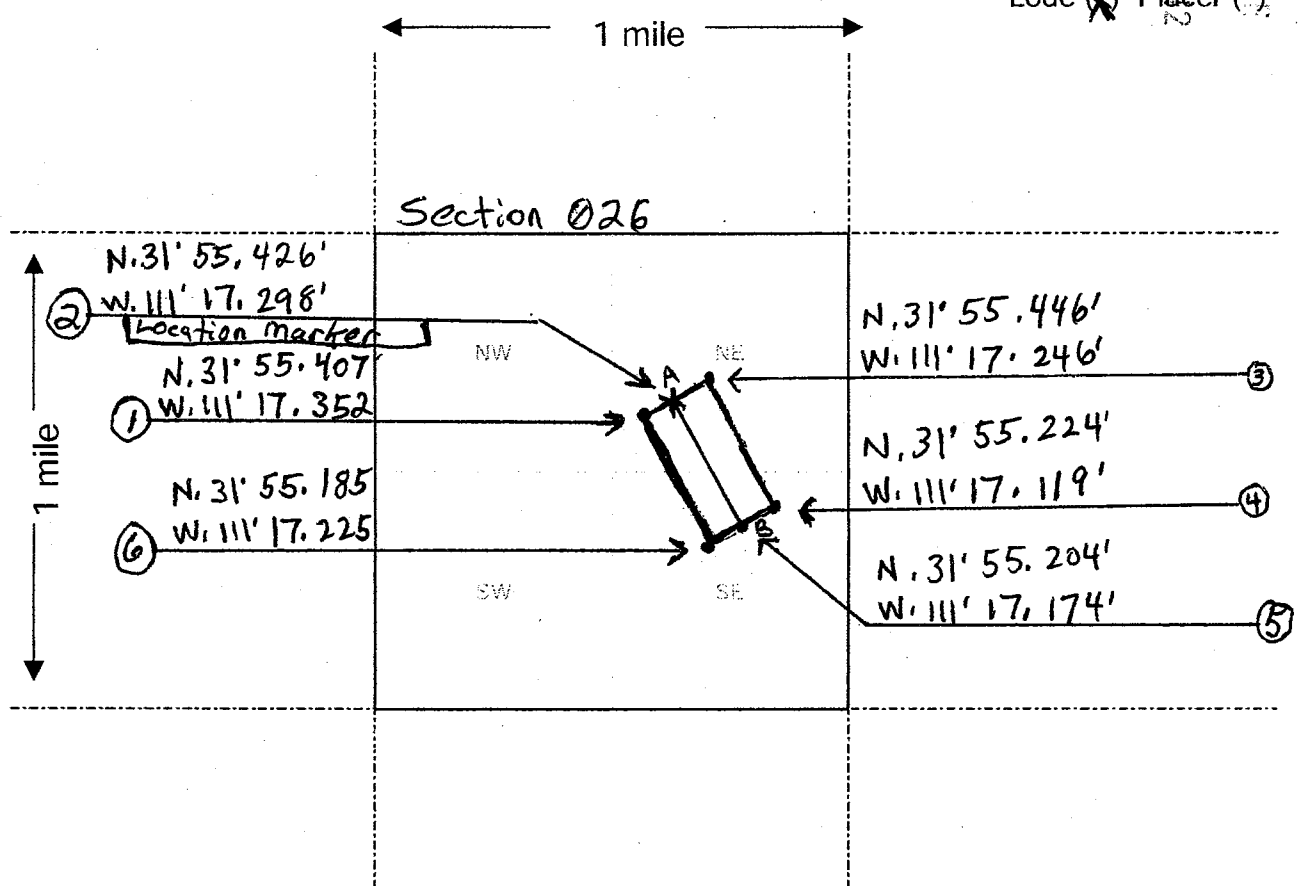

Scale : 1" = 2000 feet



- The above map depicts the Skid Mark mining claim, which is located in Section (s) 026, Township 17 S, Range 10 E, Gila and Salt River Base and Meridian, Pima County, Arizona.
- The type of corner and location monuments used are as follows: Wooden Stakes with Stones
Location notice attached inside plastic bottle on monument Post.
- The bearings and distances in degrees and feet between claim corners are as depicted on the map.

Form MCF100a
 Revised July 2005

This form is available from the Arizona Department of Mines & Mineral Resources and may be reproduced.

A1100423704

Connie Haley
PO Box 584
Green Valley, AZ 85622-0584

PHOENIX AZ 852

26 JUN 2013 PM 4 L



RECEIVED
BLM AZ STATE OFFICE

2013 JUN 27 PM 12:48

PHOENIX, ARIZONA

Bureau of Land Management
Arizona State Office
1 North Central Ave, Suite 800
Phoenix, Az. 85004

95004442700

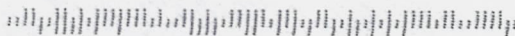

Connie Haley
PO Box 584
Green Valley, AZ 85622-0584

RECEIVED
BLM AZ STATE OFFICE

2013 JUN 27 PM 12:44

PHOENIX, ARIZONA

PHOENIX AZ 852

26 JUN 2013 PM 4 L



Bureau of Land Management
Arizona State Office
1 North Central Ave, Suite 800
Phoenix, Az. 85004

95004442700

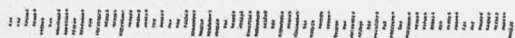

RUN TIME: 01:45 PM

RUN DATE: 07/10/2013

Page 1 of 1

DEPARTMENT OF INTERIOR
BUREAU OF LAND MANAGEMENT

Input Parameters for Geographic Report with Land

System Id = CR

Admin State = AZ

Geo State = AZ

Casetype Begins With

Case Disp Txt = AUTHORIZED, CANCELLED, EXPIRED, PENDING, REJECTED, RELINQUISHED, WITHDRAWN

Mer Twp Rng =

Section =

Mtrs = 14 0170S 0100E 026, 14 0170S 0100E 999

Commodity =

Commodity Txt =

Pending Org =

Pend Org Decode =

Total Rows Returned: 0

NO WARRANTY IS MADE BY BLM FOR USE OF THE DATA
FOR PURPOSES NOT INTENDED BY BLM

